

Aussteller / exhibitor Japan Pavillon, Exhibitor Medica
 ERP nr. PROANG00046340
 Messe / exhibition Medica Düsseldorf 2018
 Datum / date 12-Nov-18 - 15-Nov-18
 Halle / hall 16
 Stand / stand A - B39 - 33
 Maßstab / scale Zeichnungen nicht maßstabsgetreu!
 Drawings are not in scale!
 gezeichnet / drawn by heka / 118872 / 22.10.2018 / V 6

Angebot | Offer

Version / type
 BE 422

Boden / floor
 Teppichboden, Rips, anthrazit (03) / Carpet, Rips, anthracite (03)
 rot (05) / Carpet, Rips, red (05)

System (Höhe) / system (height)
 MEgawall alu / unpainted alu, +2500mm, +3500mm
 Wandfüllung weiss / infill white

Grafikfläche / graphic area
 Banner weiß / white 6000 x 1500 mm, Halopanel illuminated 990 x 3480 mm,

Grafik / graphics

Graphics, logo

1. 600 x 245mm
2. 1940 x 792mm
3. 964 x 393 mm

lichte Maße Grafik visible size graphic			
Pos. No.	Color	Graphic width	Graphic length
200	W	984	2472
201	W	964	2472
204	W	469	2472
205	W	449	2472
230	W	944	439
500	W	1940	2480
501	LED	990	3480
256	LED	990	2480
257	LED	990	1000

Freigabe / decontrol

Fertigstellung des Standbaus 24h vor Messebeginn.
 Completion of stand construction 24h before show opening.
 Service/Betreuung am letzten Aufbau-tag 8.00-18.00 Uhr.
 On site service on the last day of the installation from 8 a.m. to 6 p.m.

Diese Zeichnung ist Eigentum der Messe Düsseldorf GmbH und darf ohne deren Genehmigung (auch auszugsweise), weder geändert, vervielfältigt noch Dritten zugänglich gemacht werden.

This drawing is property of, and contains design data which is proprietary to Messe Düsseldorf GmbH. Reproduction, use, or transfer of this drawing, or any information contained herein, to others, except as specifically authorized in connection with this project only, is not permitted without written approval of Messe Düsseldorf GmbH.

© 2018 by Messe Düsseldorf GmbH

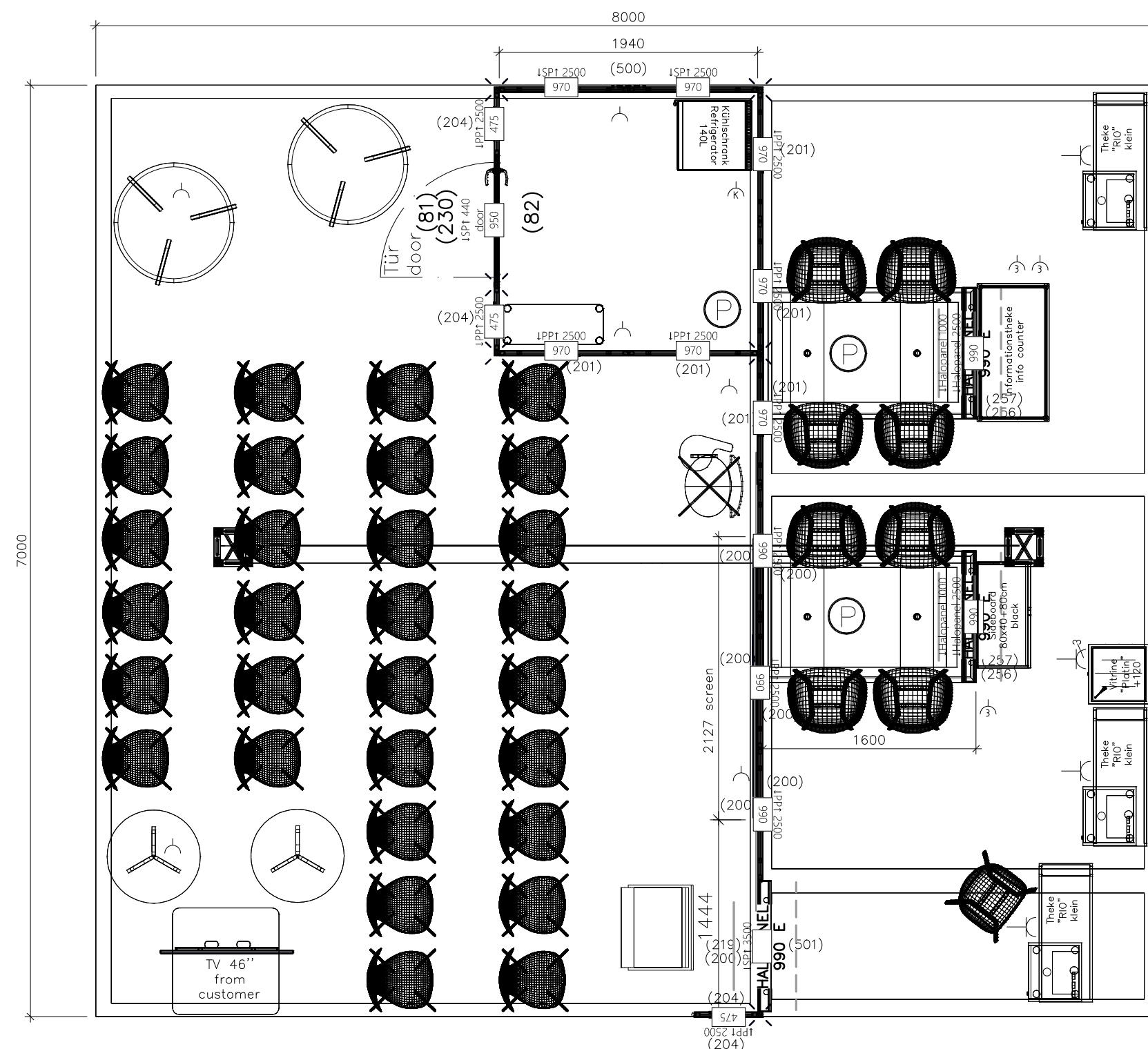

Aussteller / exhibitor Japan Pavillon, Exhibitor Medica
 ERP nr. PROANG00046340
 Messe / exhibition Medica Düsseldorf 2018
 Datum / date 12-Nov-18 - 15-Nov-18
 Halle / hall 16
 Stand / stand A - B39 - 33
 Maßstab / scale Zeichnungen nicht maßstabsgetreu!
 Drawings are not in scale!
 gezeichnet / drawn by heka / 118872 / 22.10.2018 / V 6

Angebot | Offer

Version / type
 BE 422

Boden / floor
 Teppichboden, Rips, anthrazit (03) / Carpet, Rips, anthracite (03)
 rot (05) / Carpet, Rips, red (05)

System (Höhe) / system (height)
 MEgawall alu / unpainted alu, +2500mm, +3500mm
 Wandfüllung weiss / infill white

Grafikfläche / graphic area
 Banner weiß / white 6000 x 1500 mm, Halopanel illuminated 990 x 3480 mm,

Grafik / graphics
 Firmierung / Logo

lichte Maße Grafik visible size graphic			
Pos. No.	Color	Graphic width	Graphic length
200	W	984	2472
201	W	964	2472
204	W	469	2472
205	W	449	2472
230	W	944	439
500	W	1940	2480
501	LED	990	3480
502	W	990	3520
256	LED	990	2480
257	LED	990	1000

Freigabe / decontrol

Fertigstellung des Standbaus 24h vor Messebeginn.
 Completion of stand construction 24h before show opening.
 Service/Betreuung am letzten Aufbau-tag 8.00-18.00 Uhr.
 On site service on the last day of the installation from 8 a.m. to 6 p.m.

Diese Zeichnung ist Eigentum der Messe Düsseldorf GmbH und darf ohne deren Genehmigung (auch auszugsweise), weder geändert, vervielfältigt noch Dritten zugänglich gemacht werden.

This drawing is property of, and contains design data which is proprietary to Messe Düsseldorf GmbH. Reproduction, use, or transfer of this drawing, or any information contained herein, to others, except as specifically authorized in connection with this project only, is not permitted without written approval of Messe Düsseldorf GmbH.
 © 2018 by Messe Düsseldorf GmbH

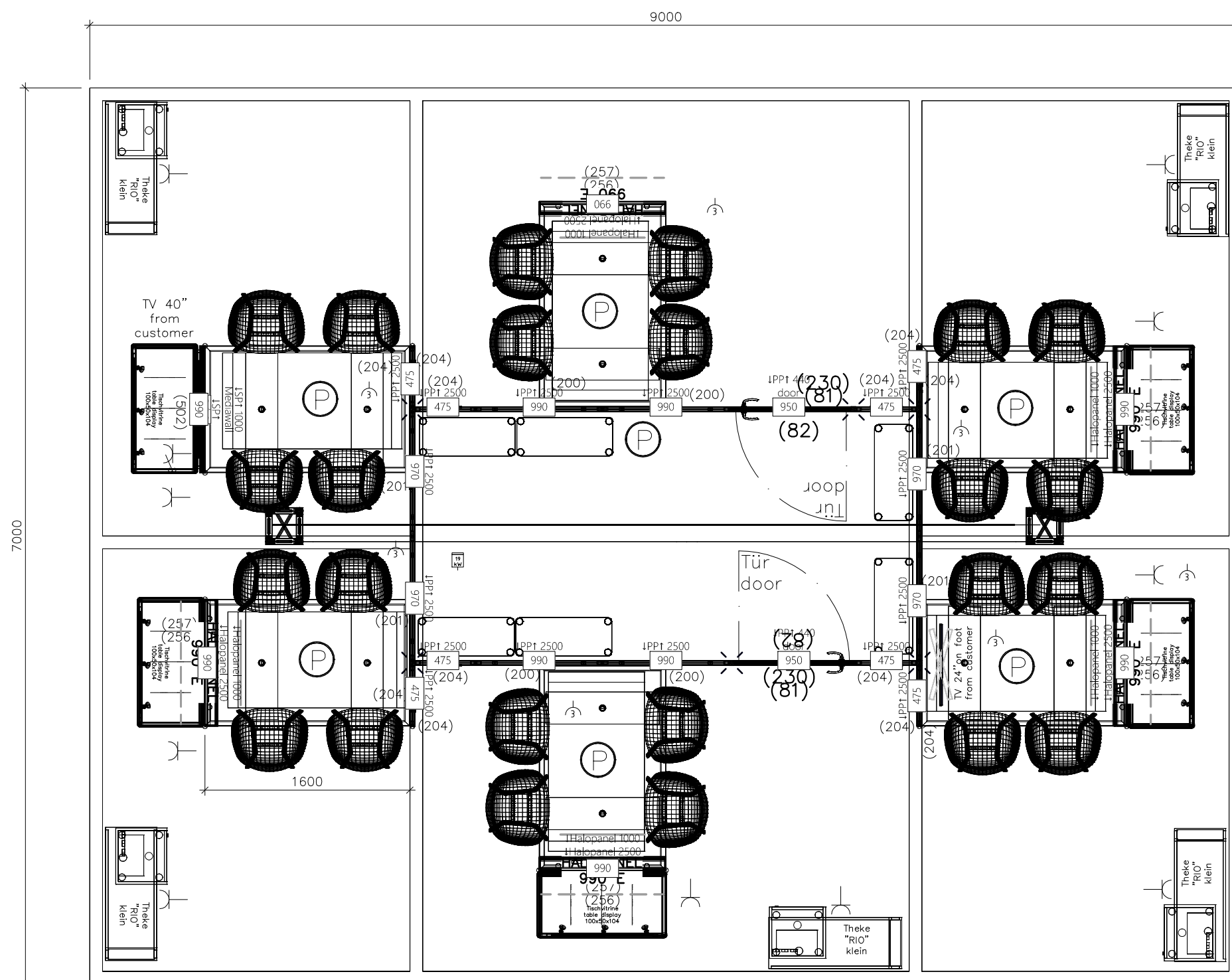
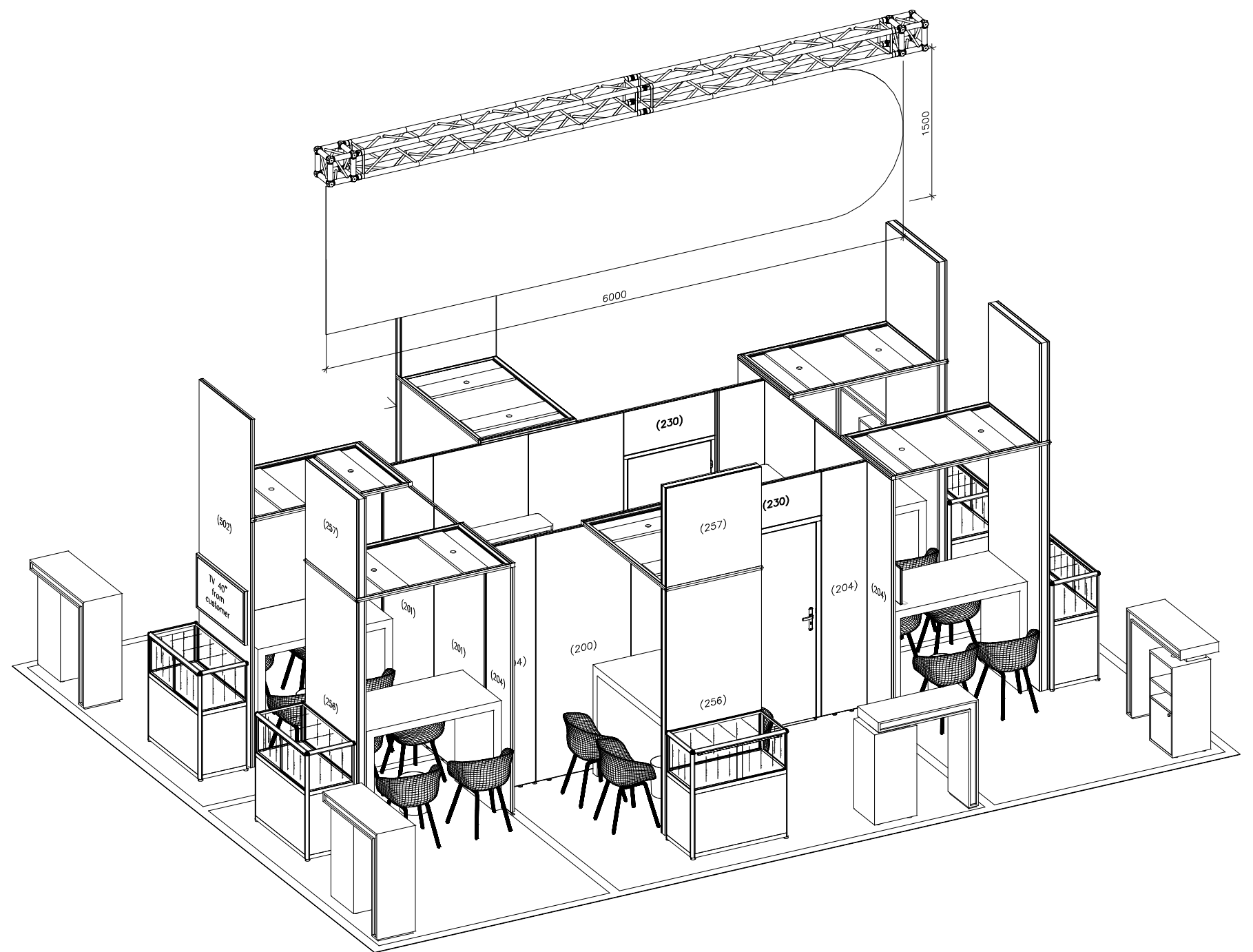

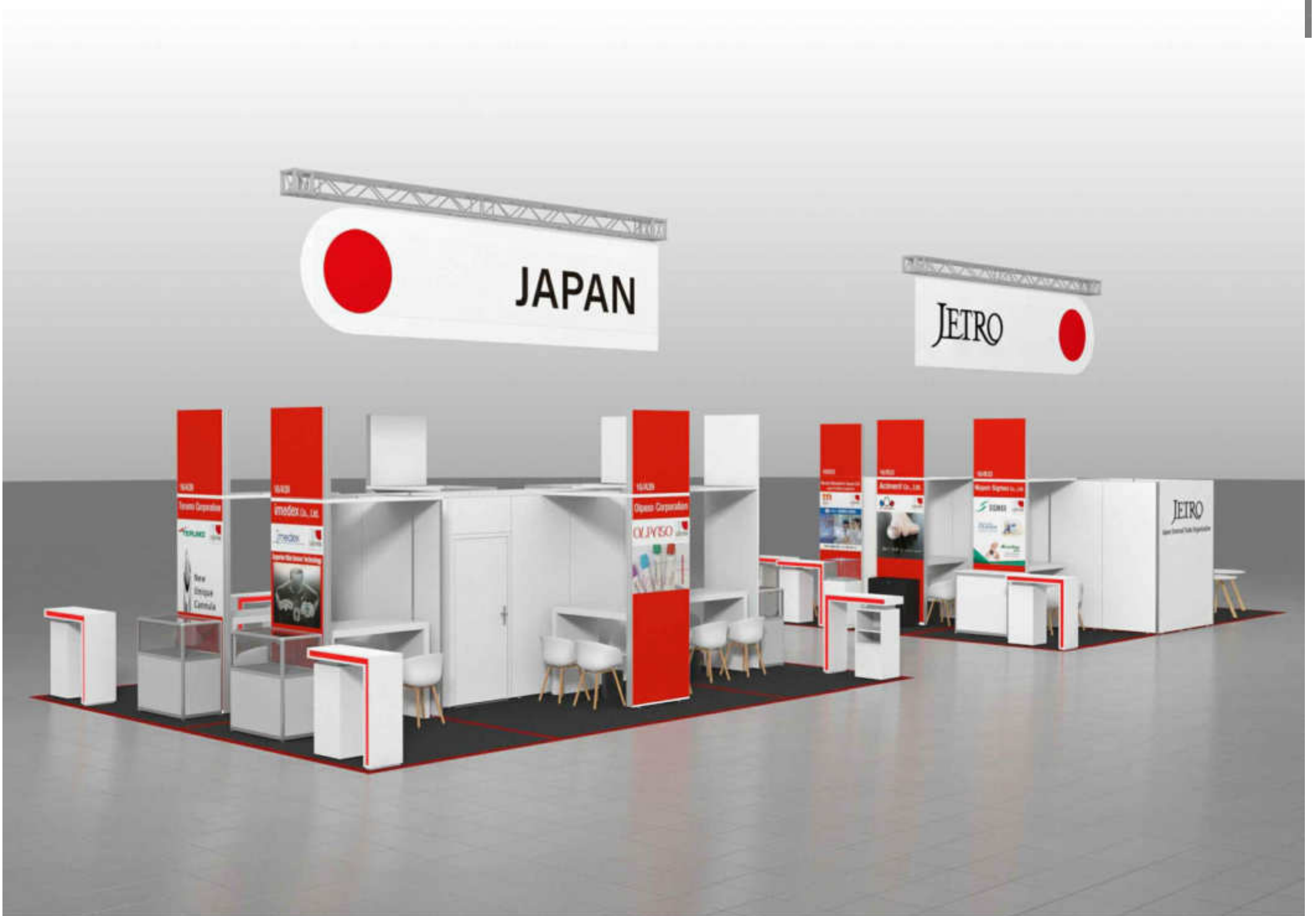



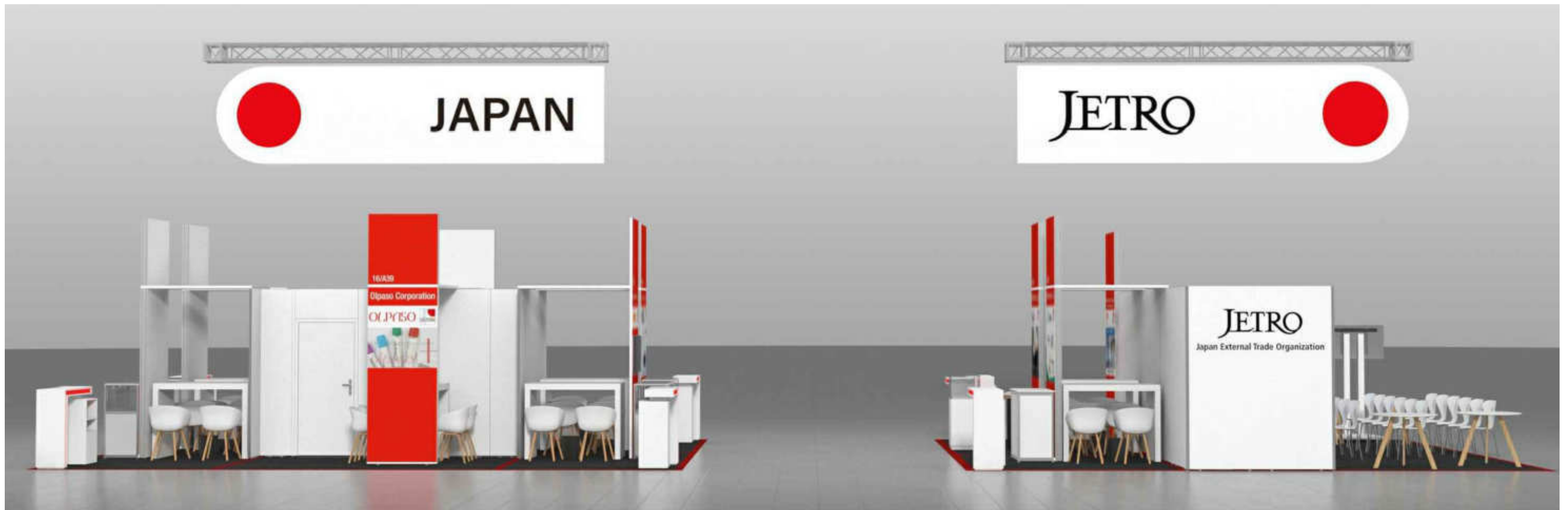

Offizieller Service-Partner
der Messe Düsseldorf GmbH



Messe
Düsseldorf

Aussteller / exhibitor
Messe / exhibition
ERP nr.

Japan Pavillon, Exhibitor Medica
Medica Düsseldorf 2018
PROANG00046340

Halle / hall
Stand / stand
CAD nr.

16
A - B39 - 33
118872

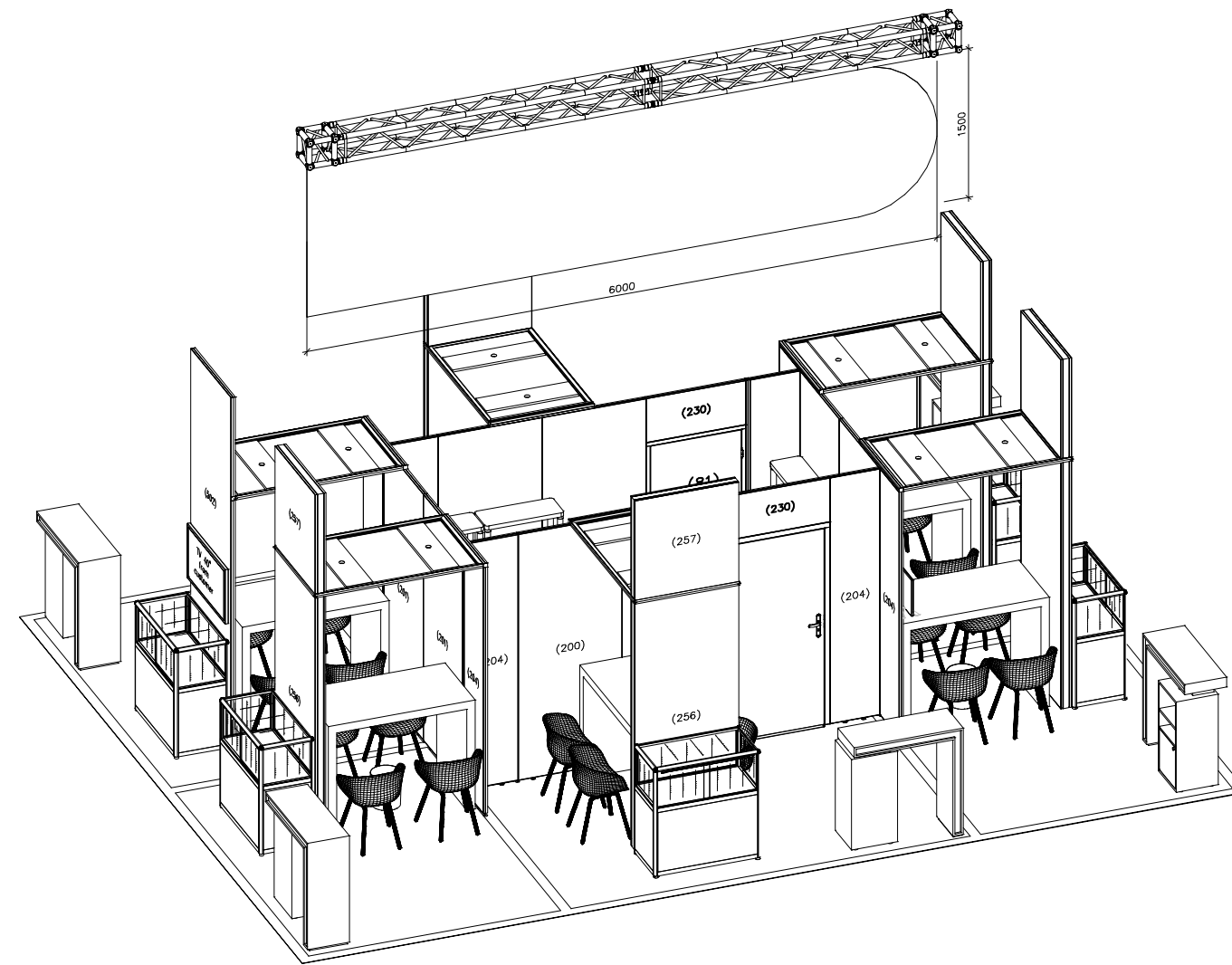
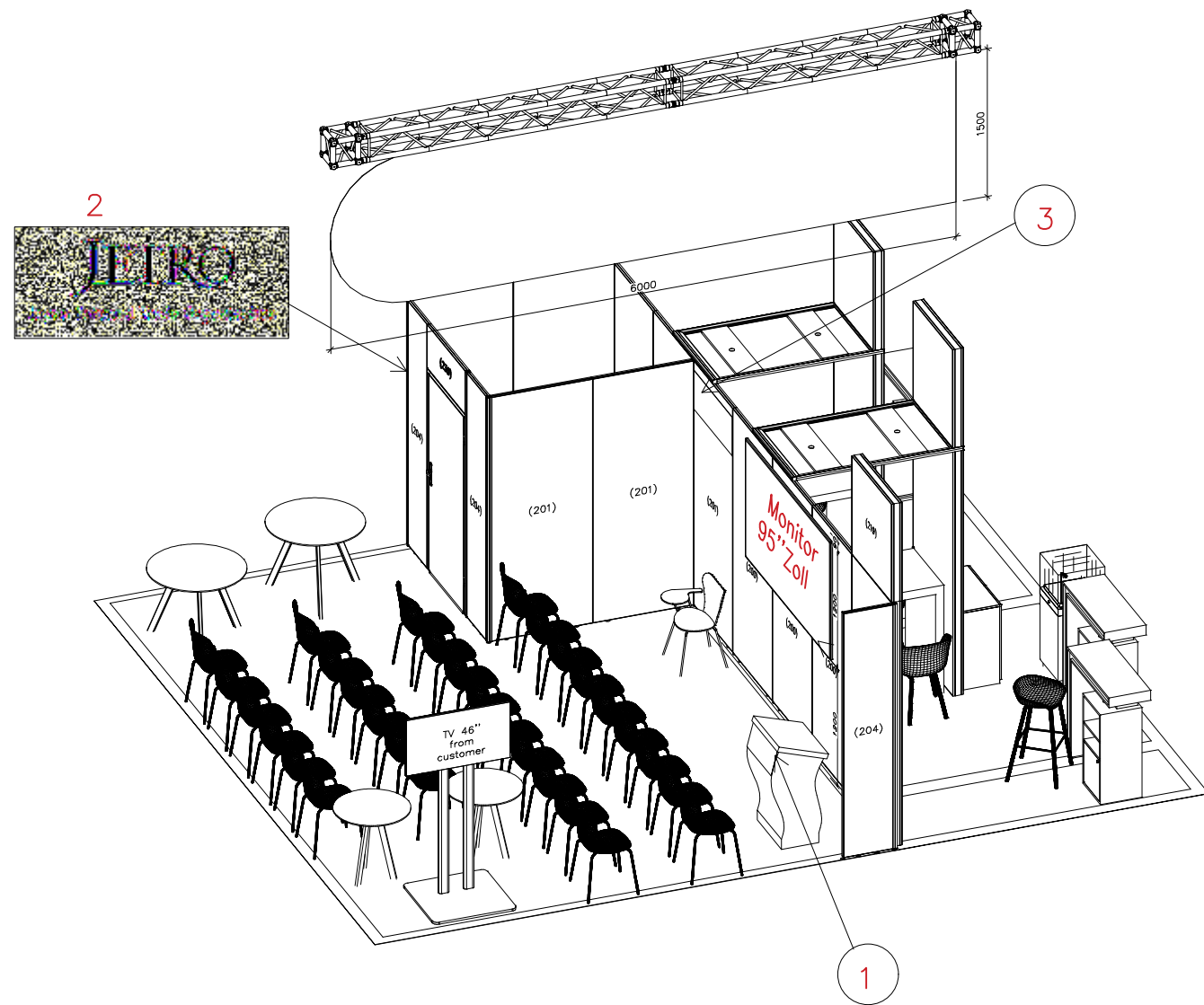

Aussteller / exhibitor Japan Pavillon, Exhibitor Medica
 ERP nr. PROANG00046340
 Messe / exhibition Medica Düsseldorf 2018
 Datum / date 12-Nov-18 - 15-Nov-18
 Halle / hall 16
 Stand / stand A - B39 - 33
 Maßstab / scale Zeichnungen nicht maßstabsgetreu!
 Drawings are not in scale!
 gezeichnet / drawn by heka / 118872 / 22.10.2018 / V 6

Angebot | Offer

Version / type
 BE 422

Boden / floor
 Teppichboden, Rips, anthrazit (03) / Carpet, Rips, anthracite (03)
 rot (05) / Carpet, Rips, red (05)

System (Höhe) / system (height)
 MEgawall alu / unpainted alu, +2500mm, +3500mm
 Wandfüllung weiss / infill white

Grafikfläche / graphic area
 Banner weiß / white 6000 x 1500 mm, Halopanel illuminated 990 x 3480 mm,

Grafik / graphics

Graphics,
 Logo

1. 600 x 245mm
2. 1940 x 792mm
3. 964 x 393 mm

lichte Maße Grafik visible size graphic			
Pos. No.	Color	Graphic width	Graphic length
200	W	984	2472
201	W	964	2472
204	W	469	2472
205	W	449	2472
230	W	944	439
500	W	1940	2480
501	LED	990	3480
502	W	990	3520
256	LED	990	2480
257	LED	990	1000

Freigabe / decontrol

Fertigstellung des Standbaus 24h vor Messebeginn.
 Completion of stand construction 24h before show opening.
 Service/Betreuung am letzten Aufbau-tag 8.00-18.00 Uhr.
 On site service on the last day of the installation from 8 a.m. to 6 p.m.

Diese Zeichnung ist Eigentum der Messe Düsseldorf GmbH und darf ohne deren Genehmigung (auch auszugsweise), weder geändert, vervielfältigt noch Dritten zugänglich gemacht werden.

This drawing is property of, and contains design data which is proprietary to Messe Düsseldorf GmbH. Reproduction, use, or transfer of this drawing, or any information contained herein, to others, except as specifically authorized in connection with this project only, is not permitted without written approval of Messe Düsseldorf GmbH.
 © 2018 by Messe Düsseldorf GmbH

