



# DIRECTORY OF JAPANESE EXHIBITORS



## MEDICA 2012

14.-17. Nov. [www.medica.de](http://www.medica.de)

## COMPAMED 2012

14.-16. Nov. [www.compamed.de](http://www.compamed.de)

Düsseldorf, GERMANY

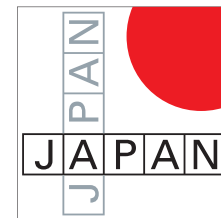
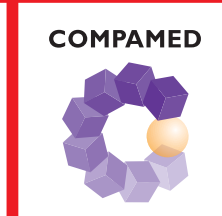

Messe  
Düsseldorf  
Japan

Hall/Stand	Exhibitor Name	Hall/Stand	Exhibitor Name
------------	----------------	------------	----------------

## MEDICA

<b>Hall 1</b> [ p6~p7 ]			
1 / A18	Apel Co., Ltd.	1 / A26	Sekisui Medical Co., Ltd
1 / B26	JOKOH Co., Ltd.	1 / E26	Tokyo Boeki Machinery Ltd.
<b>Hall 2</b> [ p8 ]			
2 / A16	WELCO Co., Ltd.		
<b>Hall 3</b> [ p9~p13 ]			
3 / H16	Asahikasei Fibers Corporation ③	3 / D65	Nippon Chemiphar Co., Ltd. ③
3 / D54	DENKA SEIKEN Co., Ltd.	3 / J26	ROHM Co., Ltd.
3 / A41	Japan Institute for the Control of Aging (JalCA), Nikken Seil Co. Ltd.	3 / H50	SCETI K.K. ① ③
3 / F63	NICHIREI BIOSCIENCES INC.	3 / K71	TAUNS Laboratories, Inc.
3 / K62	Nihon Dempa Kogyo Co., Ltd.	3 / C33	Toyobo Co., Ltd. Biochemical Dept.
<b>Hall 4</b> [ p14~p15 ]			
4 / E04	Daiya Industry Co., Ltd	4 / A35	KOKEN Co., Ltd.
4 / K36	Ito Co., Ltd.		
<b>Hall 5</b> [ p16~p17 ]			
5 / A15	Fuji Latex Co., Ltd.	5 / L21	Kawamoto Corporation
5 / P03	Kai Industries Co., Ltd.		
<b>Hall 6</b> [ p18~p20 ]			
6 / G04	Kuraraykuraflex Co., Ltd.	6 / C15	Nichiban Co., Ltd.
6 / G04	Libatape Pharmaceutical Co., Ltd.	6 / B33	Top Corporation
6 / E14	MANI, INC.	6 / B18	UNITIKA LTD.
<b>Hall 7a</b> [ p21 ]			
7.0 / A37	Alfresa Pharma Corporation ① ② ③		
<b>Hall 9</b> [ p22~p23 ]			
9 / E67	Fukuda Denshi Co., Ltd.	9 / D01	Sekisui Plastics Co., Ltd. ① ④ ⑤
9 / C47	Hadeco, Inc. ① ② ③ ④ ⑤ ⑥ ⑦	9 / B44	Toshiba Tell Corporation
<b>Hall 10</b> [ p24~p26 ]			
10 / C57	Honda Electronics Co., Ltd.		
10 / B11	Ikegami Tsushinki Co., Ltd.		
10 / E67	Nissei Japan Precision Instruments Inc.		
10 / D02	Seventh Dimension Design, Inc.		
10 / C57	Suzuken Company Ltd.		
10 / E02	Yamamoto Kogaku Co., Ltd.		
<b>Hall 11</b> [ p27~p28 ]			
11 / D78	A&D Company, Limited		
11 / H13	ATOM MEDICAL Corporation ①		
11 / H75	Tokyo Institute of Technology		
<b>Hall 12</b> [ p29 ]			
12 / B24	CANON LIFECARE SOLUTIONS		
<b>Hall 13</b> [ p30~p31 ]			
13 / C42	Sakase Chemical Co., Ltd.		
13 / A17	Yuyama Co., Ltd.		



<b>Hall 14</b> [ p31~p32 ]			
14 / D02	Excel Engineering Co., Ltd.	14 / B48	RIKUTOH CORPORATION
14 / C43	Nansin Co., Ltd.		
<b>Hall 15</b> [ p33 ]			
15 / D59	CMIC Co., Ltd.		
<b>Hall 16</b> [ p34~p51 ]			
16 / F40	Citizen Systems Japan Co., Ltd.	16 / C32	Alcare Co., Ltd.
16 / A39, B31, B39, C32, C40	Japan External Trade Organisation (JETRO)	16 / C32	ISHIKAWA MACHINERY & ELCTRONICS ASSOCIATION
16 / A39	Keisei Medical Industrial Co., Ltd.	16 / C32	Nano Corporation
16 / A39	Kyoto Kagaku Co., Ltd.	16 / C32	Nissha Printing Co., Ltd.
16 / A39	Zeon Medical Inc.	16 / C32	Shiga Prefecture Industrial Support Center
16 / B31	ATOM PRECISION TOOLS CO., LTD	16 / C40	HearMEC Co., Ltd
16 / B31	CYBERDYNE Inc.	16 / C40	JOB CORPORATION
16 / B31	E,S,Q.LTD	16 / C40	Sakamoto Sekkotsuin Ltd
16 / B31	Eyes, JAPAN Co., Ltd.	16 / C40	TSK Laboratory, Japan
16 / B31	HAYASHI SEIKI SEIZO CO., LTD	16 / F50	Kobe City Industrial Promotion Foundation
16 / B31	Kaneko Manufacturing Co., Ltd.	16 / F50	ATONARP INC.
16 / B31	P and M Co., Ltd.	16 / F50	Cosmos Corporation
16 / B31	TOKO CO., LTD.	16 / F50	ECOUS Corp.
16 / B39	ACTMENT CO., Ltd.	16 / F50	Furuno Electric Co., Ltd.
16 / B39	Japan Bio Products Co., Ltd.	16 / A35	Messe Düsseldorf Japan Ltd.
16 / B39	Medical Support Research Organization Co., Ltd.	16 / B12	Pacific Medico Co., Ltd.
16 / B39	Shinshu Medical Industry Association		

## COMPAMED

<b>Hall 8a</b> [ p52~p57 ]			
8a / J33	Hitachi Regional Industrial Technical Support Center	8a / J33	NISINO SEIKI CO., Ltd.
8a / J33	Daiichi Fab Tech, Co., Ltd.	8a / J33	Nogamigiken Co., Ltd.
8a / J33	Imahashi Co., Ltd	8a / J33	Ohnuki Manufacturing Industry Co., Ltd.
8a / J33	KAWAI IRON WORKS CO., LTD	8a / J33	OTSUKA Factory Co., Ltd.
8a / J33	M.TECH Co., Ltd	8a / J33	Sattespring Co., Ltd.
8a / J33	MITOSEIKO CO., LTD	8a / K36	Iwate Industry Promotion Center
<b>Hall 8b</b> [ p58~p62 ]			
8b / K12	EPSON ATMIX CORPORATION	8b / F41	KYOWASEIKO.CO., LTD
8b / F26	Futaku Precision Machinery Industry Comp	8b / F41	Natsume Optical Corporation JAPAN
8b / E30	MIKURO SPRING CO., LTD	8b / F41	Shinshu Ceramics Co., Ltd.
8b / F41	Nagano Techno Foundation Medical Industry Support Center	8b / J17	UNISIS Corp.
8b / F41	JMC Corporation ①	8b / K12	Yoshinogawa Electric Wire and Cable Co., Ltd. ①
8b / F41	Kyoshin Co., Ltd.		

The exhibitors with the number(s) indicated on the right side of their names are interested in dealing foreign products in home market in Japan, for example as a distributor. The interested products groups are classified as follows:

- ① Electromedical equipment / Medical Technology
- ② Laboratory Equipment
- ③ Diagnostics
- ④ Physiotherapy / Orthopaedic Technology
- ⑤ Commodities and Consumer Goods
- ⑥ Information and Communication Technology
- ⑦ Medical Services and Publications



## Block Diagram



company name	booth
1 Apel Co., Ltd.	A18
2 JOKOH Co., Ltd.	B26
3 Sekisui Medical Co., Ltd.	A26
4 Tokyo Boeki Machinery Ltd. Medical Instruments Division	E26

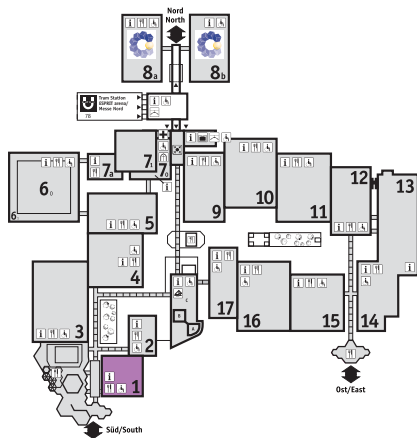

## 1 Apel Co., Ltd.

 1/A18

## Contact Data

951 Angyouryou Negishi  
333-0834 Kawaguchi, Saitama, Japan

Phone: +81 48 2803055  
Fax: +81 48 2852309  
<http://www.apel.co.jp>  
[sales@apel.co.jp](mailto:sales@apel.co.jp)

## Company Figures

**Number of employees** 1-19  
**Sales volume** 1-9 Mio US \$  
**Export content** > 75%  
**Year of foundation** 1976

## Area of business

- Electromedical equipment / Medical Technology
- Laboratory Equipment
- Diagnostics

## Product Information

- Analyser appliances
- UV-VIS spectrophotometers
- Spectrometers
- Centrifuges
- Bilirubinometers/bilimeters
- Devices and systems for haemoglobin determination

## 2 JOKOH Co., Ltd.



1/B26

## Contact Data

3-19-4 Hongo, Bunkyo-ku  
111-0033 Tokyo, Japan

Phone: +81 3 3814-1981  
Fax: +81 3 3815-1759  
<http://www.jokoh.com/e-index.html>  
[worldwide@jokoh.com](mailto:worldwide@jokoh.com)

## Company Figures

**Number of employees** 100-499  
**Sales volume** 50-99 Mio US \$  
**Export content** max. 10%  
**Year of foundation** 1947  
**Area of business** Diagnostics

## Product Information

- Laboratory equipment

## 3 Sekisui Medical Co., Ltd.



1/A26

## Contact Data

13-5, Nihombashi 3-chome, Chuo-ku,  
KDX Nihombashi 313 Building 5F  
103-0027 Tokyo, Japan

Phone: +81 3 32720671  
Fax: +81 3 32720907  
<http://www.sekisui-medical.jp/english>  
[hori048@sekisui.jp](mailto:hori048@sekisui.jp)

## Product Information

- Product Categories

4 Tokyo Boeki Machinery Ltd.  
Medical Instruments Division

1/E26

## Contact Data

2-13-8, Hatchobori, Chuo-ku  
104-8510 Tokyo, Japan

Phone: +81 3 3555-7353  
Fax: +81 3 3555-7367  
<http://www.tokyo-boeki-machinery.jp/>  
[info-madical@tokyo-boeki.co.jp](mailto:info-madical@tokyo-boeki.co.jp)

## Company Figures

**Number of employees** 100-499  
**Sales volume** 200-499 Mio US \$  
**Export content** > 75%  
**Year of foundation** 2006  
**Area of business** Laboratory Equipment

## Product Information

- Laboratory equipment

## Block Diagram

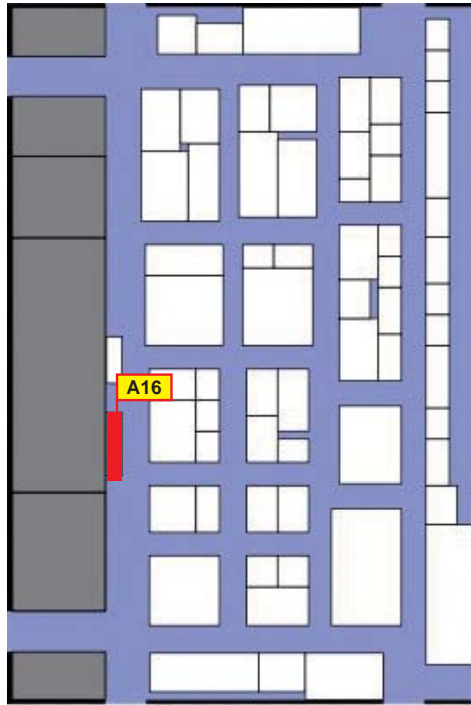

company name	booth
1 Furuno Electric Co. Ltd. System Products Division MEBU	D32
2 WELCO Co., Ltd.	A16

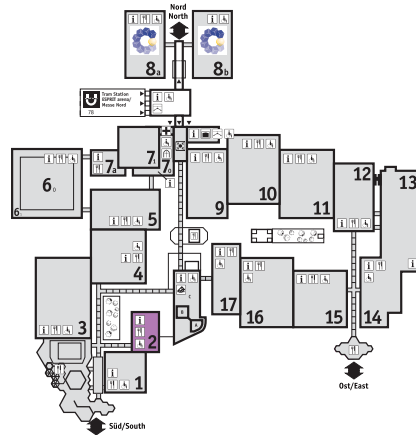

## 1 WELCO Co., Ltd.



2/A16

### Contact Data

3-3-1 Sumiyoshi-Cho, Fuchu-Shi  
183-0034 Tokyo, Japan

Phone: +81 42 3337311  
Fax: +81 42 3337313  
<http://www.welco.net>  
[sales@welco.net](mailto:sales@welco.net)

### Company Figures

**Number of employees** 50-99  
**Sales volume** 10-49 Mio US \$  
**Export content** max. 10%  
**Year of foundation** 1971  
**Area of business** Laboratory Equipment

### Product Information

- Pumps and valves for laboratories

## Block Diagram

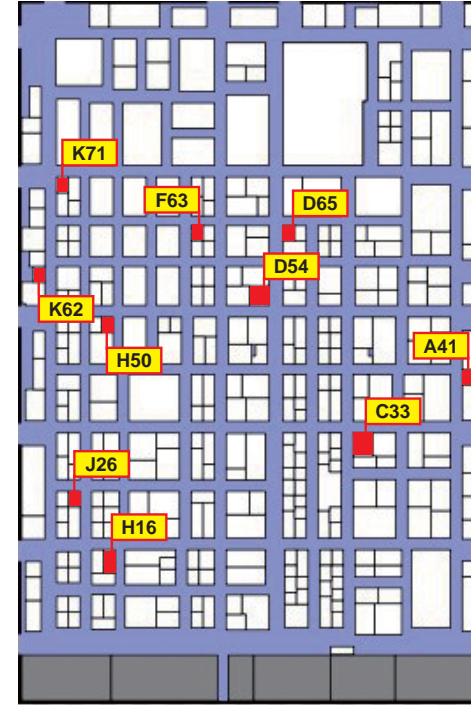

company name	booth
1 Asahikasei Fibers Corporation CNB Business Promotion Dep.	H16
2 DENKA SEIKEN Co., Ltd.	D54
3 Japan Institute for the Control of Aging (JalCA), Nikken Seil Co. Ltd.	A41
4 NICHIREI BIOSCIENCES INC.	F63
5 Nihon Dempa Kogyo Co., Ltd.	K62
6 Nippon Chemiphar Co., Ltd.	D65
7 ROHM Co.,Ltd Research and Development Headquarters Medical Sensing Unit (L3-2)	J26
8 SCETI K.K.	H50
9 TAUNS Laboratories, Inc.	K71
10 Toyobo Co., Ltd. Biochemical Dept.	C33

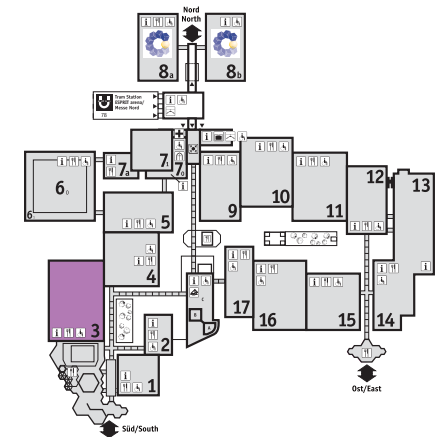

# AsahiKASEI

## Contact Data

4-3400-1, Asahi-machi, Nobeoka  
882-0047 Miyazaki, Japan

Phone: +81 982 224003  
Fax: +81 982 224202  
<http://www.asahi-kasei.co.jp/fibers/en>  
[okubo.nb@om.asahi-kasei.co.jp](mailto:okubo.nb@om.asahi-kasei.co.jp)

We proudly exhibit unique materials for lateral flow immunoassay such as NanoAct™, colored nano-sized cellulose label that contribute to increase sensitivity and rapidity of assays. Also we exhibit Bemliese™, high absorbency and flow rate continuous cellulosic fibers sample pad.

## Company Figures

**Number of employees** > 5000  
**Sales volume** > 500 Mio US \$  
**Export content** max. 50%  
**Year of foundation** 1931  
**Area of business** Diagnostics

## Product Information

- Rapid tests - clinical chemistry
- Substrates
- Units and systems for hormone determination
- Diagnostic agents / kits for hormone determination
- Reagents for hormone determination
- Accessories for hormone determination

## Contact Data

1-1 Nihonbashi-Muromachi, 2 Chome Chuo-ku  
103-8338 Tokyo, Japan

Phone: +81 3 62143236  
Fax: +81 3 62143246  
<http://www.denka-seiken.jp>  
[seiken@denka-seiken.co.jp](mailto:seiken@denka-seiken.co.jp)

## Company Figures

**Number of employees** 500-999  
**Sales volume** 100-199 Mio US \$  
**Export content** max. 25%  
**Year of foundation** 1950  
**Area of business** Diagnostics

## Product Information

- Units and systems for clinical chemistry
- Diagnostic agents / kits for clinical chemistry
- Anemia related / Vitamin tests
- Immuno assay systems
- Enzyme immunoassay (EIA, ELISA, EMIT)
- Photometric assay
- Units and systems for the determination of immunoglobulins and plasma proteins

## Contact Data

710-1 Haruoka, Fukuroi-shi  
437-0122 Shizuoka, Japan

Phone: +81 538 490125  
Fax: +81 538 491267  
<http://www.jaica.com/e>  
[biotech@jaica.com](mailto:biotech@jaica.com)

## Company Figures

**Number of employees** 1-19  
**Sales volume** 1-9 Mio US \$  
**Export content** max. 50%  
**Year of foundation** 1985

## Area of business

- Laboratory Equipment
- Diagnostics

## Product Information

- Immuno assay systems
- Enzyme immunoassay (EIA, ELISA, EMIT)

# NICHIREI

## Contact Data

6-19-20, Tsukiji, Chuo-ku  
104-8402 Tokyo, Japan

Phone: +81 3 32482207  
Fax: +81 3 32482243  
<http://www.nichirei.co.jp/bio/english>  
[sakamotoykn@nichirei.co.jp](mailto:sakamotoykn@nichirei.co.jp)

## Company Figures

**Number of employees** 100-499  
**Sales volume** 10-49 Mio US \$  
**Export content** max. 25%  
**Year of foundation** 1983

## Area of business

- Laboratory Equipment
- Diagnostics

## Product Information

- Immuno assay systems
- Enzyme immunoassay (EIA, ELISA, EMIT)
- Heterogenous enzyme immunoassay
- Histology / Cytology reagents

We manufacture detection reagents, *N-Histofine*® for immunohistochemistry (IHC). These products use the UIP (Universal Immuno-enzyme Polymer), which is our patented technology. It provides wonderful staining results, higher sensitivity, lower background and time-saving. We also supply OEM products.

## 5 Nihon Dempa Kogyo Co., Ltd.

 3/K62

### Contact Data

Sasazuka NA Bldg., 1-50-1 Sasazuka, Shibuya-ku  
151-8569 Tokyo, Japan

Phone: +81 3 54536736  
Fax: +81 3 54536822  
<http://www.ndk.com/en/index.html>  
bio-m@ndk.com

### Company Figures

**Number of employees** 1000-4999  
**Sales volume** 200-499 Mio US \$  
**Export content** max. 75%  
**Year of foundation** 1948

### Area of business

- Electromedical equipment / Medical Technology
- Laboratory Equipment
- Diagnostics

### Product Information

- Ultrasound diagnostic equipment
- Ultrasound scanners
- Analyser appliances

## 6 Nippon Chemiphar Co., Ltd.

 3/D65

### Contact Data

2-2-3, Iwamoto-cho, Chiyoda-ku  
101-0032 Tokyo, Japan

Phone: +81 3 38512974  
Fax: +81 3 38622645  
<http://www.chemiphar.co.jp/english>  
oriton@chemiphar.co.jp

### Company Figures

**Number of employees** 500-999  
**Sales volume** 200-499 Mio US \$  
**Export content** max. 10%  
**Year of foundation** 1950  
**Area of business** Diagnostics

### Product Information

- Allergies

## 7 ROHM Co.,Ltd

 3/J26



### Contact Data

21 Saiin Mizosaki-cho, Ukyo-ku  
615-8585 Kyoto, Japan

Phone: +81 75 3211255  
Fax: +81 75 3111316  
<http://www.rohm.co.jp/web/eu>  
medicalsales@rohm.co.jp

### Company Figures

**Number of employees** 1000-4999  
**Sales volume** > 500 Mio US \$  
**Export content** max. 75%  
**Year of foundation** 1958  
**Area of business** Diagnostics

### Product Information

- Devices and systems for haemoglobin determination
- Fully automatic glycosylated haemoglobin determination
- Rapid tests - clinical chemistry
- Point of care - testing systems
- Auto-immune diseases
- Diagnostics / kits for the diabetes analyses

## 8 SCETI K.K.

 3/H50

### Contact Data

3-6-7 Kasumigaseki, Chiyoda-ku  
100-0013 Tokyo, Japan

Phone: +81 3 55102652  
Fax: +81 3 55100133  
<http://www.sceti.jp/export>  
tsakamachi@sceti.co.jp

### Company Figures

**Number of employees** 100-499  
**Sales volume** 10-49 Mio US \$  
**Export content** max. 10%  
**Year of foundation** 1952  
**Area of business** Diagnostics

### Product Information

- Units and systems for clinical chemistry
- Blood sampling material and systems for clinical chemistry
- Diagnostic agents / kits for clinical chemistry
- Semi-automatic units for clinical chemistry
- Mechanical units for clinical chemistry
- Reagents for clinical chemistry

## 9 TAUNS Laboratories, Inc.

 3/K71

### Contact Data

761-1, Kamishima, Izunokuni  
410-2325 Shizuoka, Japan

Phone: +81 558 768181  
Fax: +81 558 760022  
<http://tauns.jp/english>  
k\_uehara@tauns.co.jp

### Company Figures

**Number of employees** 50-99  
**Sales volume** 10-49 Mio US \$  
**Export content** max. 10%  
**Year of foundation** 1987  
**Area of business** Diagnostics

### Product Information

- Rapid tests - Immunochemistry
- Infectious disease tests
- Rapid tests - Microbiology
- Rapid tests - Infectious immunology

## 10 Toyobo Co., Ltd. Biochemical Dept.

 3/C33

### Contact Data

2-2-8, Dojima-Hama, Kita-ku  
530-8230 Osaka, Japan

Phone: +81 6 63483846  
Fax: +81 6 63483833  
<http://www.toyobo.co.jp>  
tadanobu\_matsumura@toyobo.jp

### Company Figures

**Number of employees** > 5000  
**Sales volume** > 500 Mio US \$  
**Export content** max. 25%  
**Year of foundation** 1882  
**Area of business** Diagnostics

### Product Information

- Enzymes

## Block Diagram

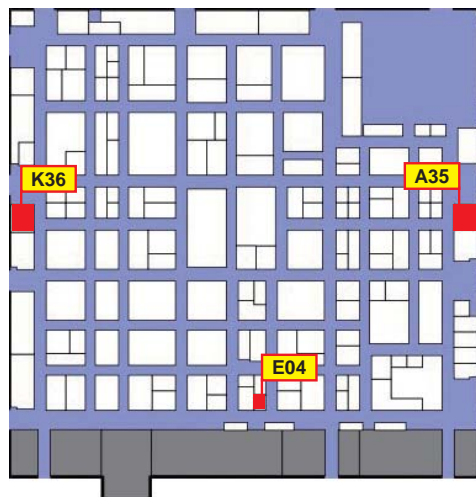

company name	booth
1 Daiya Industry Co.,Ltd	E04
2 ITO Co., Ltd.	K36
3 KOKEN Co., Ltd.	A35

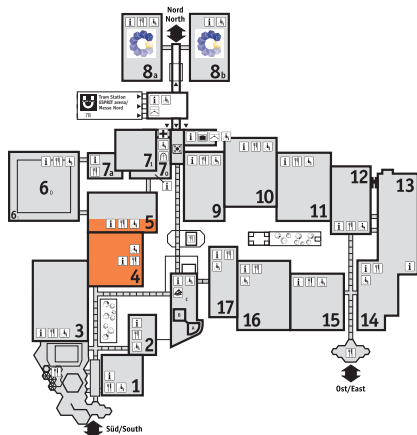

## 1 Daiya Industry Co.,Ltd

## Contact Data

1117-1, Koshinden, Minamiku, Okayamashi  
701-0203 Okayama, Japan

Phone: +81 86 2821245  
Fax: +81 86 2821246  
<http://www.daiyak.co.jp>  
ida@daiyak.co.jp

## Company Figures

**Number of employees** 50-99  
**Sales volume** 10-49 Mio US \$  
**Export content** max. 10%  
**Year of foundation** 1963  
**Area of business**

- Physiotherapy / Orthopaedic Technology

## Product Information

- Bandages (Physiotherapy / Orthopaedic Technology)

## 2 ITO Co., Ltd.

## Contact Data

3-3-3, Toyotama-Minami, Nerima-Ku  
176-0014 Tokyo, Japan

Phone: +81 3 39944619  
Fax: +81 3 39941465  
<http://www.itolator.co.jp>  
ma-watanabe@itolator.co.jp

## Company Figures

**Number of employees** 100-499  
**Sales volume** 50-99 Mio US \$  
**Export content** max. 25%  
**Year of foundation** 1916

## Area of business

- Physiotherapy / Orthopaedic Technology

## Product Information

- Electro-therapy equipment
- Frequency therapy equipment
- Magnetic field therapy
- Micro wave therapy devices

## 3 KOKEN Co., Ltd.

## Contact Data

1-4-14 Koraku, Bunkyo-ku  
112-0004 Tokyo, Japan

Phone: +81 3 38163562  
Fax: +81 3 38163582  
<http://www.kokenmpc.co.jp>  
customer@kokenmpc.co.jp

## Company Figures

**Number of employees** 100-499  
**Sales volume** 10-49 Mio US \$  
**Export content** max. 25%

## Area of business

- Electromedical equipment / Medical Technology



## Block Diagram



company name	booth
1 Fuji Latex Co., Ltd.	A15
2 Kai Industries Co., Ltd.	E06
3 Kawamoto Corporation	L21

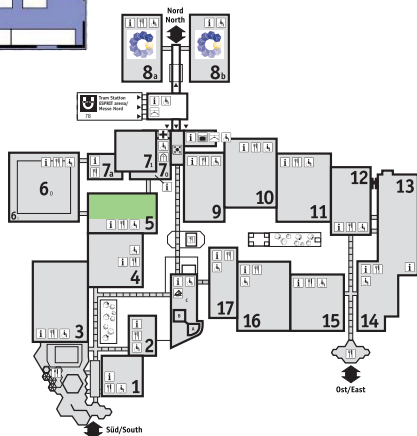

## 1 Fuji Latex Co., Ltd.

 5/A15

## Contact Data

19-1, 3-Chome Nishiki-cho, Chiyoda-ku  
101-0054 Tokyo, Japan

Phone: +81 3 32592530  
Fax: +81 3 32936070  
<http://www.fujilatex.co.jp>  
[jun-fukano@fujilatex.co.jp](mailto:jun-fukano@fujilatex.co.jp)

## Company Figures

**Number of employees** 100-499  
**Sales volume** 50-99 Mio US \$  
**Export content** max. 25%  
**Year of foundation** 1949  
**Area of business**  
• Commodities and Consumer Good for Surgeries and Hospitals

## Product Information

- Universal medical commodities
- Condoms

## 2 Kai Industries Co., Ltd.

 5/P03

## Contact Data

1110 Oyana  
501-3992 Seki City, Gifu, Japan

Phone: +81 575 286600  
Fax: +81 575 286611  
<http://www.kai-ind.co.jp>  
[info-ind@kai-group.com](mailto:info-ind@kai-group.com)

## Company Figures

**Number of employees** 500-999  
**Year of foundation** 1908  
**Area of business**

- Commodities and Consumer Goods for Surgeries and Hospitals

## Product Information

- Surgical instruments and products
- Surgical disposable instruments
- Other general surgical instruments and equipment
- Universal medical commodities
- Disposable articles for surgeries
- Disposable articles for hospitals

## 3 Kawamoto Corporation

 5/L21

## Contact Data

4-1, Itoyamachi 2-Chome, Chuo-ku  
540-0022 Osaka, Japan

Phone: +81 6 69438991  
Fax: +81 6 69439081  
<http://www.kawamoto-sangyo.co.jp>  
[kbm@kawamoto-sangyo.co.jp](mailto:kbm@kawamoto-sangyo.co.jp)

## Company Figures

**Number of employees** 500-999  
**Year of foundation** 1914  
**Area of business**

- Commodities and Consumer Good for Surgeries and Hospitals

## Product Information

- Disposable articles for surgeries

## Block Diagram

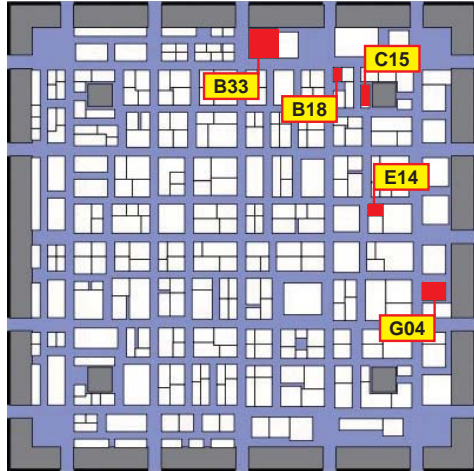

company name	booth
1 Kuraraykuraflex Co. Ltd.	G04
2 Libatape Pharmaceutical Co., Ltd.	G04
3 MANI, INC.	E14
4 Nichiban Co., Ltd.	C15
5 Top Corporation	B33
6 UNITIKA LTD.	B18

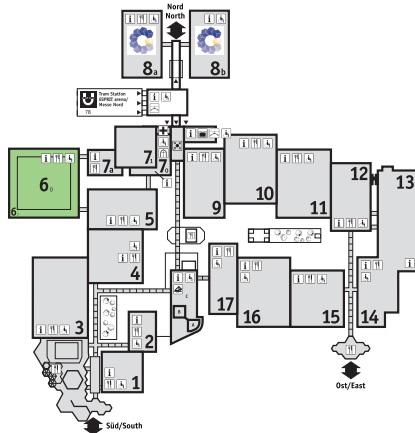

## 1 Kuraraykuraflex Co. Ltd.

6/G04

## Contact Data

8-1, Kukudacho, Kita-Ku  
530-8611 Osaka, Japan

Phone: +81 6 7635-1560  
Fax: +81 6 7635-1561  
<http://www.kuraray.co.jp>  
Kurarflex\_Info@kuraray.co.jp

## Product Information

- Dressings for wounds

## 2 Libatape Pharmaceutical Co., Ltd.

6/G04

## Contact Data

45 Iwano, Ueki-machi, Kumamoto-shi,  
861-0136 Kumamoto, Japan

Phone: +81-96-272-0631  
Mobile: +81-80-3910-9618  
Fax: +81-96-275-1036  
<http://www.libatape.co.jp>  
n-nishioka@libatape.co.jp

## Company Figures

**Number of employees** 100-499  
**Sales volume** 50-99 Mio US \$  
**Export content** max. 10%  
**Year of foundation** 1960

## Area of business

- Commodities and Consumer Good for Surgeries and Hospitals

## Product Information

- Universal medical commodities
- Bandages (Universal medical commodities)
- Hands disinfection articles
- Disposable articles for surgeries
- Bandage materials

## 3 MANI, INC.

6/E14

## Contact Data

8-3 Kiyohara Industrial Park  
321-3231 Utsunomiya, Tochigi, Japan

Phone: +81 28 6678346  
Fax: +81 28 6678305  
<http://www.mani.co.jp/en/index.html>  
surgical@ms.mani.co.jp

## Company Figures

**Number of employees** 1000-4999  
**Sales volume** 100-199 Mio US \$  
**Export content** max. 75%  
**Year of foundation** 1959

## Area of business

- Electromedical equipment / Medical Technology

## Product Information

- Surgical instruments and products
- Surgical disposable instruments
- Surgical needles
- Surgical suture materials
- Instruments and apparatus for cardiac and thoracic surgery

## 4 Nichiban Co., Ltd.

6/C15



## Contact Data

2-3-3 Sekiguchi, Bunkyo-ku  
112-8663 Tokyo, Japan

Phone: +81 3 59785636  
Fax: +81 3 59782890  
<http://www.nichiban.co.jp/en/>  
ibd@nichiban.co.jp / sakagami@nichiban.co.jp

## Company Figures

**Number of employees** 500-999  
**Sales volume** > 500 Mio US \$  
**Export content** max. 10%  
**Year of foundation** 1918

## Area of business

- Commodities and Consumer Good for Surgeries and Hospitals

## Product Information

- Dialysis equipment
- Dialysis testing and monitoring equipment
- Haemodialysis equipment and accessories
- Rescue equipment and appliances
- First aid bandages

## 5 Top Corporation

JAPAN 6/B33



### Contact Data

19-10, Senjunakai-cho, Adachi-Ku  
120-0035 Tokyo, Japan

Phone: +81 3 38823105  
Fax: +81 3 38818163  
<http://www.top-tokyo.co.jp>  
boueki@top-tokyo.co.jp

### Product Information

- Infusion technology equipment
- Feeding tubes
- Infusion devices
- Infusion pumps
- Syringes
- Syringe pumps

## 6 UNITIKA LTD.

JAPAN 6/B18

### Contact Data

4-1-3 Kyutaro-machi, Chuo-ku  
541-8566 Osaka, Japan

Phone: +81-6 62815021  
Fax: +81-6 62815256  
<http://www.unitika.co.jp/e>  
medical@unitika.co.jp

**Number of employees** 1000-4999  
**Sales volume** > 500 Mio US \$  
**Export content** max. 25%  
**Year of foundation** 1889

### Product Information

- Enzymes
- Units and systems for clinical chemistry
- Reagents for clinical chemistry
- Equipment and systems for microbiological diagnosis/virology
- Reagents for microbiological diagnosis
- Catheters (Commodities and Consumer Goods)
- Dressings for wounds

## Hall 7o



### Block Diagram



company name	booth
1 Alfresa Pharma Corporation	A37

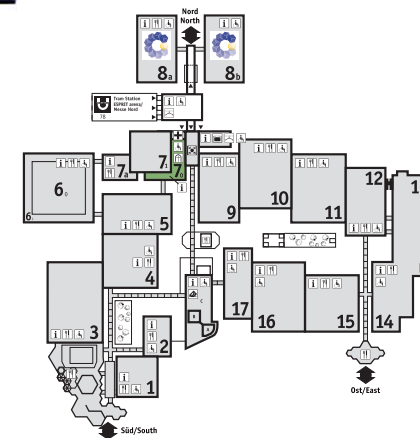

## 1 Alfresa Pharma Corporation

JAPAN 7o/A37

### Contact Data

2-9 Kokumachi, 2-chome, Chuo-ku  
540-8575 Osaka, Japan

Phone: +81 6 69410368  
Fax: +81 6 69471549  
<http://www.alfresa-pharma.co.jp>  
info@alfresa-pharma.co.jp

### Company Figures

**Number of employees** 500-999  
**Sales volume** 200-499 Mio US \$  
**Export content** max. 10%  
**Year of foundation** 1939

### Area of business

- Electromedical equipment / Medical Technology
- Laboratory Equipment
- Diagnostics
- Commodities and Consumer Good for Surgeries and Hospitals

### Product Information

- Infusion technology equipment
- Conserved blood and accessories (blood bags, warming devices, etc.)
- Sterilisation and disinfection equipment and accessories / autoclaves

## Block Diagram



company name	booth
1 Fukuda Denshi Co., Ltd.	E67
2 Hadeco, Inc.	C47
3 Sekisui Plastics Co., Ltd.	D01
4 Toshiba Teli Corporation	B44

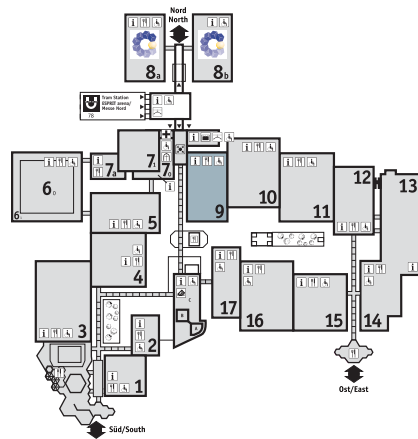

## 1 Fukuda Denshi Co., Ltd.

## Contact Data

39-4Hongo-3chome, Bunkyo-ku  
113-8420 Tokyo, Japan

Phone: +81 3 5684-1455  
Fax: +81 3 3814-1222  
<http://www.fukuda.com>

## Company Figures

**Number of employees** 1000-4999  
**Sales volume** > 500 Mio US \$  
**Export content** max. 10%  
**Year of foundation** 1948

## Area of business

- Electromedical equipment / Medical Technology
- Medical Services and Publications

## Product Information

- Electrocardiography (ECG) equipment and accessories
- Patient monitoring systems / Measuring stations
- Ultrasound Scanner
- Vascular Screening device
- Cardiac catheterisation equipment

## 2 Hadeco, Inc.

## Contact Data

2-7-11, Arima, Miyamae-ku, Kawasaki  
216-0003 Kawasaki, Japan

Phone: +81 44 8774361  
Fax: +81 44 8557301  
<http://www.hadeco.co.jp>  
[export\\_s9@hadeco.co.jp](mailto:export_s9@hadeco.co.jp)

## Company Figures

**Number of employees** 50-99  
**Sales volume** 1-9 Mio US \$  
**Export content** > 75%  
**Year of foundation** 1948

## Area of business

- Electromedical equipment / Medical Technologies

## Product Information

- Ultrasound diagnostic equipment
- Doppler sonography equipment and accessories

## 3 Sekisui Plastics Co., Ltd.

## Contact Data

2-7-1 Nishi-shinjuku, Shinjuku-ku  
163-0727 Tokyo, Japan

Phone: +81 3 33479628  
Fax: +81 3 53223861  
<http://www.stgel.com>  
[furusa06@sekisuiplastics.co.jp](mailto:furusa06@sekisuiplastics.co.jp)

## Company Figures

**Number of employees** 1000-4999  
**Sales volume** > 500 Mio US \$  
**Export content** max. 25%  
**Year of foundation** 1959

## Area of business

- Diagnostics
- Commodities and Consumer Good for Surgeries and Hospitals

## Product Information

- Electrodes and biosensors

## 4 Toshiba Teli Corporation

## Contact Data

4-7-1, Asahigaoka, Hino-shi  
191-0065 Tokyo, Japan

Phone: +81 42 5898771  
Fax: +81 42 5898774  
<http://www.toshiba-teli.co.jp>  
[teli\\_glb@toshiba-teli.co.jp](mailto:teli_glb@toshiba-teli.co.jp)

## Company Figures

**Number of employees** 100-499  
**Sales volume** 100-199 Mio US \$  
**Export content** max. 25%  
**Year of foundation** 1950

## Area of business

- Electromedical equipment / Medical Technology

## Product Information

- Endoscopes and accessories

## Block Diagram



company name	booth
1 Honda Electronics Co., Ltd.	C57
2 Ikegami Tsushinki Co., Ltd.	B11
3 Nissei Japan Precision Instruments Inc.	E67
4 Seventh Dimension Design, Inc.	D02
5 Suzuken Company Ltd.	C57
6 Yamamoto Kogaku Co., Ltd.	E02

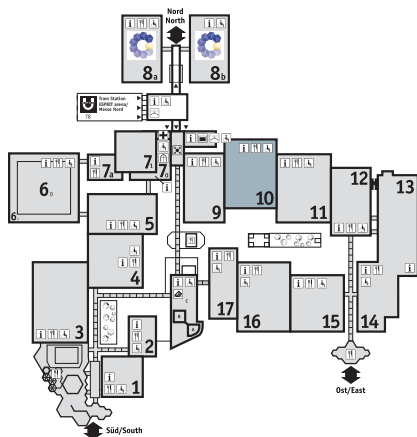

## 1 Honda Electronics Co., Ltd.

 10/C57

## Contact Data

20 Oymazuka, Oiwa-cho  
441-3193 Toyohashi, Aichi, Japan

Phone: +81 532 412514  
Fax: +81 532 414441  
<http://www.honda-el.co.jp>  
me@honda-el.co.jp

## Company Figures

**Number of employees** 100-499  
**Sales volume** 1-9 Mio US \$  
**Export content** max. 50%  
**Year of foundation** 1956  
**Area of business**  
• Electromedical equipment / Medical Technology

## Product Information

- Ultrasound diagnostic equipment
- Doppler sonography equipment and accessories
- Echocardiographs and evaluation systems
- Colour dopplers
- Transcranial dopplers
- Ultrasound ocular diagnosis, B-mode

## 2 Ikegami Tsushinki Co., Ltd.

 10/B11

## Contact Data

5-6-16 Ikegami ohta-ku  
146-8567 Tokyo, Japan

Phone: +81 3 57001111  
<http://www.ikegami.co.jp/en>  
info\_e@ikegami.co.jp

## Company Figures

**Number of employees** 500-999  
**Sales volume** 200-499 Mio US \$  
**Export content** max. 25%  
**Year of foundation** 1946

## Area of business

- Electromedical equipment / Medical Technology

## Product Information

- System for Image documentation
- Endoscopes and accessories
- Video endoscopes, CCD cameras
- Educational appliances
- Cameras for medical photography

## 3 Nissei Japan Precision Instruments Inc.

 10/E67

## Contact Data

2508-13 Nakago Shibukawa  
377-0293 Gunma, Japan

Phone: +81 279 202311  
Fax: +81 279 202411  
<http://www.nissei-jp.com/index1.html>  
k-arai@nissei-jp.com

## Company Figures

**Number of employees** 100-499  
**Sales volume** 50-99 Mio US \$  
**Export content** max. 75%  
**Year of foundation** 1950

## Area of business

- Electromedical equipment / Medical Technology

## Product Information

- Blood pressure equipment
- Aneroid devices
- Blood pressure self-monitoring instruments
- Electronic blood pressure manometers and accessories
- Long-term blood pressure equipment

## 4 Seventh Dimension Design, Inc.

 10/D02

## Contact Data

7F, Sannomiya INTES, 7-1-8, Isogami-dori, Chuo-ku  
651-0086 Kobe, Japan

Phone: +81 78 2528867  
Fax: +81 78 2528856  
<http://sdd.jp/en/index.html>  
isales@sdd.jp

## Product Information

- System for Image documentation

## 5 Suzuken Company Ltd.

JAPAN 10/C57

### Contact Data

8, Higashi Kataha-machi, Higashi-ku  
461-0015 Nagoya, Aichi, Japan

Phone: +81 52 9506327

Fax: +81 52 9627440

<http://www.suzuken-kenz.com>

[hi.ozawa@suzuken.co.jp](mailto:hi.ozawa@suzuken.co.jp)

### Product Information

- Electrocardiograph (ECG) equipment and accessories.
- Holter ECG/ABPM.
- Stress Test ECG
- Blood Pressure equipment.
- Blood Warmer.

## 6 Yamamoto Kogaku Co., Ltd.

JAPAN 10/E02

### Contact Data

25-8, Chodo-3, Higashiosaka City  
577-0056 Osaka, Japan

Phone: +81 6 67831101

Fax: +81 6 67887393

<http://www.yamamoto-kogaku.co.jp>

[usui@yamamoto-kogaku.co.jp](mailto:usui@yamamoto-kogaku.co.jp)

### Company Figures

**Number of employees** 100-499

**Sales volume** 50-99 Mio US \$

**Export content** max. 10%

**Year of foundation** 1911

### Area of business

- Commodities and Consumer Good for Surgeries and Hospitals

### Product Information

- Laser therapy equipment
- YAG lasers
- Ultraviolet and Infrared radiation equipment
- Laser surgery equipment

## Hall 11



### Block Diagram

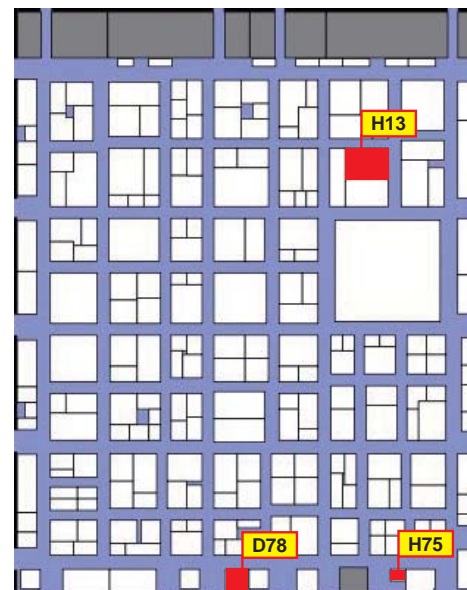

	company name	booth
1	A&D Company, Limited	D78
2	ATOM MEDICAL Corporation	H13
3	Tokyo Institute of Technology Office of Industry Liaison	H75

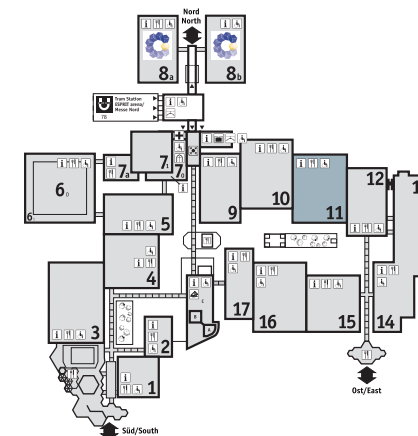

## 1 A&D Company, Limited

JAPAN 11/D78

### Contact Data

3-23-14, Higashi-Ikebukuro, Toshima Ku  
170-0013 Tokyo, Japan

Phone: +81 3 53916120

Fax: +81 3 53916148

<http://www.aandd.jp>

### Company Figures

**Number of employees** 500-999

**Sales volume** 200-499 Mio US \$

**Export content** max. 50%

**Year of foundation** 1977

### Area of business

- Electromedical equipment / Medical Technology

### Product Information

- Scales
- Personal scales
- Blood pressure equipment
- Blood pressure self-monitoring instruments
- Electronic blood pressure manometers and accessories

**Contact Data**

3-18-15 Hongo, Bunkyo-Ku  
113-0033 Tokyo, Japan

Phone: +81 3 3815-2941  
Fax: +81 3 3812-4080  
Fax: +81 3 3812-9670  
<http://www.atomed.co.jp/english/matsumoto@atom-ami.co.jp>

**Company Figures**

**Number of employees** 100-499  
**Sales volume** 100-199 Mio US \$  
**Export content** max. 25%  
**Year of foundation** 1938  
**Area of business**  
• Electromedical equipment / Medical Technology

**Product Information**

• Incubators

**Contact Data**

2-12-1, Ookayama, Meguro-ku  
152-8550 Tokyo, Japan

Phone: +81 35734 7693  
Fax: +81 35734 7694  
<http://www.titech.ac.jp>  
watari@sangaku.titech.ac.jp

**Company Figures**

**Number of employees** > 5000  
**Year of foundation** 1881

**Product Information**

• Endoscopes and accessories  
• Endoscopy systems

**Block Diagram**



company name	booth
1 CANON LIFECARE SOLUTIONS	B24

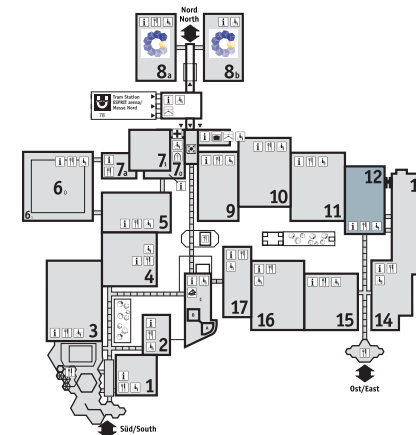

**Contact Data**

2-17-4 Yushima Bunkyo-Ku  
113-0034 Tokyo, Japan

Phone: +81 3 3818-1324  
Fax: +81 3 3818-1814  
kat\_murai@elkc.co.jp

## Block Diagram



company name	booth
1 Sakase Chemical Co., Ltd.	C42
2 Yuyama Co., Ltd.	A17

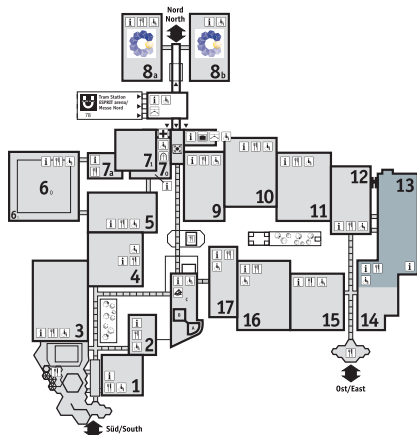

## 1 Sakase Chemical Co., Ltd.

## Contact Data

Imon Iwamoto Bldg., 3-3-6 Iwamoto-cho Chiyoda-ku  
101-0032 Tokyo, Japan

Phone: +81 3 3862-8826  
Fax: +81 3 3864-1050  
<http://www.sakase.com>  
[int-dept@sakase.com](mailto:int-dept@sakase.com)

## Company Figures

**Number of employees** 100-499  
**Sales volume** 10-49 Mio US \$  
**Export content** max. 10%  
**Year of foundation** 1962  
**Area of business**  
• Electromedical equipment / Medical Technology

## Product Information

- Modular systems

## 2 Yuyama Co., Ltd.

## Contact Data

3-3-1 Meishinguchi, Toyonaka  
561-0841 Osaka, Japan

Phone: +81 66332 2538  
Fax: +81 66333 1971  
<http://www.yuyama.co.jp>  
[ys\\_trade@yuyama.co.jp](mailto:ys_trade@yuyama.co.jp)

## Company Figures

**Number of employees** 500-999  
**Sales volume** 200-499 Mio US \$  
**Export content** max. 10%  
**Year of foundation** 1964

## Product Information

- Ward equipment and apparatus

## Hall 14

## Block Diagram

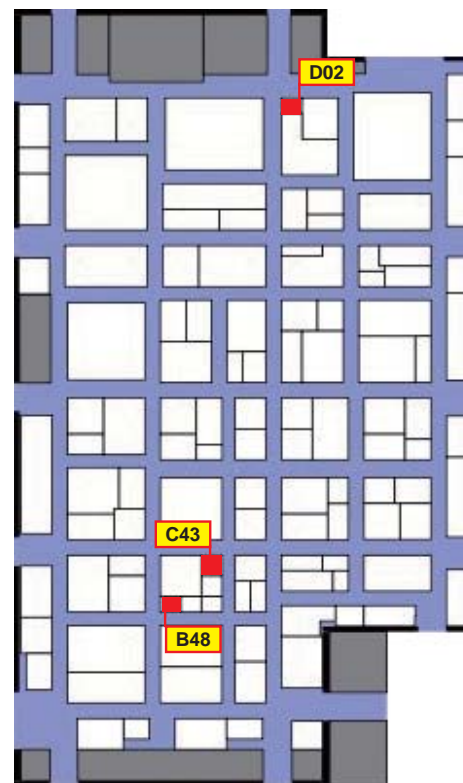

company name	booth
1 Excel Engineering Co., Ltd.	D02
2 Nansin Co., Ltd.	C43
3 RIKUTOH CORPORATION	B48

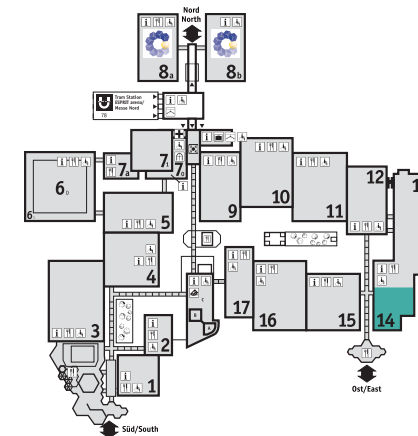



## 1 Excel Engineering Co., Ltd.

JAPAN 14/D02

### Contact Data

Sakata Bldg. 5F 4-2-10, Nihonbashi-Muromachi,  
Chuo-ku  
103-0022 Tokyo, Japan

Phone: +81 3 35161560  
Fax: +81 3 32311530  
<http://www.excel-jpn.com/>  
excel@excel-jpn.com

### Company Figures

**Number of employees** 20-49  
**Sales volume** 1-9 Mio US \$  
**Export content** max. 10%  
**Year of foundation** 1996

### Area of business

- Electromedical equipment / Medical Technology
- Information and Communication Technology

### Product Information

- Ward equipment and apparatus

## 2 Nansin Co., Ltd.

JAPAN 14/C43

### Contact Data

2-1, Midoridai 1-Chome, Inzai-City  
270-2331 Chiba, Japan

Phone: +81 476 885561  
Fax: +81 3 885527  
<http://www.nansin.co.jp>  
jh5493@nansin.co.jp

### Company Figures

**Number of employees** 100-499  
**Sales volume** 50-99 Mio US \$  
**Export content** max. 10%  
**Year of foundation** 1932

### Area of business

- Commodities and Consumer Good for Surgeries and Hospitals
- Medical Services and Publications

### Product Information

- Laboratory equipment

## 3 RIKUTOH CORPORATION

JAPAN 14/B48

### Contact Data

3-14-3 Hongo, Bunkyo-ku  
113-0033 Tokyo, Japan

Phone: +81 3 8137045  
Fax: +81 3 8137014  
<http://www.rikutoh.co.jp>  
nataki@rikutoh.co.jp

### Company Figures

**Number of employees** 20-49  
**Sales volume** 50-99 Mio US \$  
**Export content** max. 10%  
**Year of foundation** 1989

### Area of business

- Electromedical equipment / Medical Technology
- Physiotherapy / Orthopaedic Technology

### Product Information

- Magnetic Resonance Imaging (MRI)
- Wheelchairs

## Hall 15

MEDICA

### Block Diagram

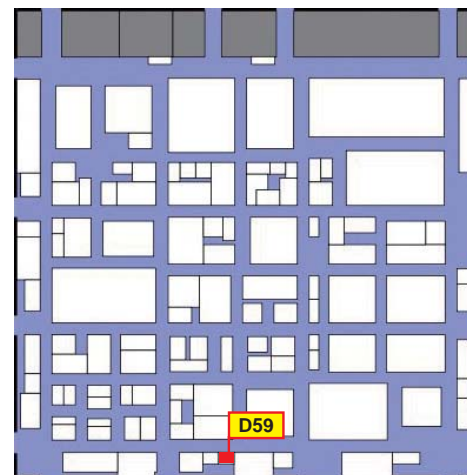

	company name	booth
1	CMIC Co.,Ltd.	D59

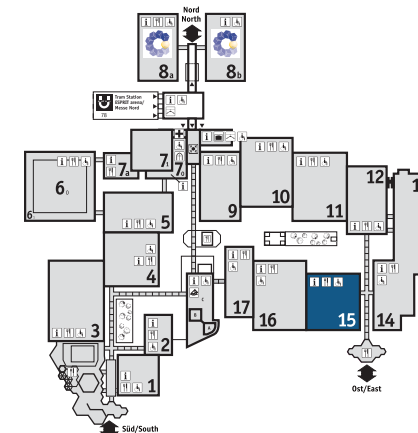

## 1 CMIC Co.,Ltd.

JAPAN 15/D59

### Contact Data

Kongo Bldg., 7-10-4 Nishigotanda, Shinagawa-ku  
141-0031 Tokyo, Japan

Phone: +81 3 57457070  
<http://www.cmic-holdings.co.jp/e/>  
information@cmic.co.jp

### Company Figures

**Number of employees** 1000-4999  
**Sales volume** > 500 Mio US \$  
**Year of foundation** 1985

### Area of business

- Medical Services and Publications

### Product Information

- Business development
- Consulting for health organisations

company name	booth
1 Citizen Systems Japan Co., Ltd.	F40
2 Japan External Trade Organisation - JETRO Manufacturing and Environment Industry Department	A39, B31, B39, C32, C40
3 Keisei Medical Industrial Co., Ltd.	A39
4 Kyoto Kagaku Co., Ltd.	A39
5 Zeon Medical Inc.	A39
6 ATOM PRECISION TOOLS CO.,LTD	B31
7 CYBERDYNE Inc.	B31
8 E,S,Q.LTD	B31
9 Eyes, JAPAN Co. Ltd.	B31
10 HAYASHI SEIKI SEIZO CO., LTD	B31
11 Kaneko Manufacturing Co., Ltd.	B31
12 P and M Co., Ltd.	B31
13 TOKO CO., LTD.	B31
14 ACTMENT CO.,Ltd.	B39
15 Japan Bio Products Co., Ltd.	B39
16 Medical Support Research Organization Co., Ltd.	B39
17 Shinshu Medical Industry Association	B39
18 Alcare Co., Ltd.	C32
19 ISHIKAWA MACHINERY & ELCTRONICS ASSOCIATION	C32
20 Nano Corporation	C32
21 Nissha Printing Co., Ltd.	C32
22 Shiga Prefecture Industrial Support Center	C32
23 HearMEC Co.,Ltd	H40
24 JOB CORPORATION	H40
25 Sakamoto Sekkotsuin Ltd (Sakamoto Hallux Valgus Development Laboratory)	H40
26 TSK Laboratory, Japan	H40
27 Kobe City Industrial Promotion Foundation	F50
28 ATONARP INC.	F50

29 Cosmos Corporation	F50
30 ECOUS Corp.	F50
31 Furuno Electric Co. Ltd.	F50
32 Messe Düsseldorf Japan Ltd.	A35
33 Pacific Medico Co. Ltd.	B12

## Block Diagram

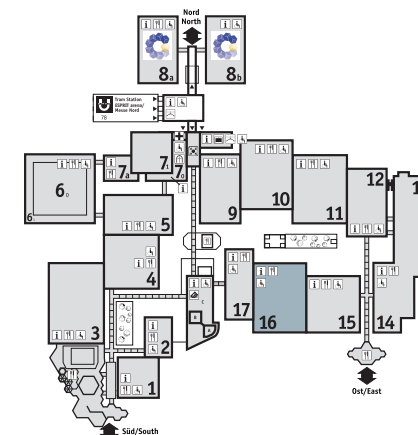
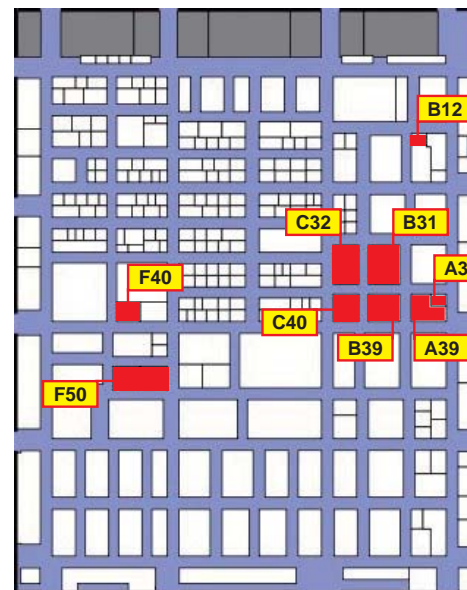

## 1 Citizen Systems Japan Co., Ltd.

**16/F40**

### Contact Data

6-1-12, Tanashi-Cho, Nishi-Tokyo-shi  
188-8511 Tokyo, Japan

Phone: +81 424 684988  
Fax: +81 424 684996  
<http://www.citizen-systems.co.jp>  
[hattori@systems.citizen.co.jp](mailto:hattori@systems.citizen.co.jp)

### Company Figures

**Number of employees** 100-499  
**Year of foundation** 2005

#### Area of business

- Electromedical equipment / Medical Technology
- Information and Communication Technology

### Product Information

- Blood pressure equipment



Japan External Trade Organization

**Contact Data**

12-32 Akasaka 1-Chome, Minato-ku  
107-6006 Tokyo, Japan

Phone: +81 3 35825183  
Fax: +81 3 35050450  
<http://www.jetro.go.jp>

**Company Figures**

Number of employees 1000-4999

**Product Information**

- Professional institutions
- Associations and organisations

As the organizer of the Japan Pavilion, JETRO is pleased to support the participation of 24 exhibitors in this year's MEDICA. We will be joined by Fukushima Pref. as the special exhibitor to help bolster international commerce for Fukushima, which was hit by the Great East Japan Earthquake.



KEISEI MEDICAL INDUSTRIAL CO., LTD.

**Contact Data**

3-19-6 Hongo Bunkyo-Ku  
113-0033 Tokyo, Japan

Phone: +81 3 38165851  
Fax: +81 3 38162941  
<http://www.keiseimed.com>  
[tfukuyama@keiseimed.com](mailto:tfukuyama@keiseimed.com)

**Company Figures**

Number of employees 50-99  
Sales volume 10-49 Mio US \$  
Export content max. 10%  
Year of foundation 1964

- Area of business**
- Electromedical equipment / Medical Technology

Since 1964, Keisei Medical is a dedicated plastic surgery products manufacturer such as air fluidized bed, electric dermatome/mesher, skin stapler, needle and suture, surgical instruments, implants, and so on. ISO 13485 certified, CE marking approved, FDA registered.

LI-7 Air Fluidized Support System reduces surface contact pressure to the minimum. Operative beads volume 30% less than the average of industry. Low noise and Low exhaust air for patients comfort and clean/quiet environment.

KED-101 Electric dermatome uses finger friendly Dial for thickness setting. Powered by AC mains, operator is free from battery management. Operated with voltage 100~240V. Graft width settings 40,50,60,70,80mm,. Graft thickness setting 20steps, 0.075, 0.15, 0.225, ...~1.5mm.

Looking for distributor in Europe, Middle East, South East Asia, etc.



Simulators, Training Models & Phantoms



Contact Data

15 Kitanekeoya-cho, Fushimi-ku  
612-8388 Kyoto, Japan

Phone: +81 75 6052510  
Fax: +81 75 6052519  
[http://www.kyotokagaku.com/  
rw-kyoto@kyotokagaku.co.jp](http://www.kyotokagaku.com/rw-kyoto@kyotokagaku.co.jp)

Since 1948, Kyoto Kagaku has been helping medical and educational institutions by offering a wide array of unique skills training products. For Medica2012, featured products includes: Fetus Ultrasound Examination Phantom, Tube Feeding Simulator, Clinical Skills Trainers and Radiology Phantoms.

Company Figures

Number of employees 100-499  
Sales volume 10-49 Mio US \$  
Export content max. 25%  
Year of foundation 1948  
Area of business  
• Medical Services and Publications

Product Information

- Educational appliances
- Medical educational equipment



Contact Data

Shiba-Park Bldg. B, 2-4-1 Shiba-koen, Minato-ku  
105-0011 Tokyo, Japan

Phone: +81 3 35787728  
Fax: +81 3 35787749  
<http://www.zeonmedical.co.jp>  
m.yagi@zeon.co.jp

Zeon Medical Inc. founded in 1989 has over 20 years history for production and distribution of cardiovascular products in IABP, PTCA and PPI field. Started Sales of CE marked Intra Aortic Balloon Catheter worldwide since 2011. Our safe & creative catheters support cardiovascular treatment.

Company Figures

Number of employees 100-499  
Year of foundation 1989  
Area of business  
• Electromedical equipment / Medical Technology

Product Information

- Catheters (Commodities and Consumer Goods)

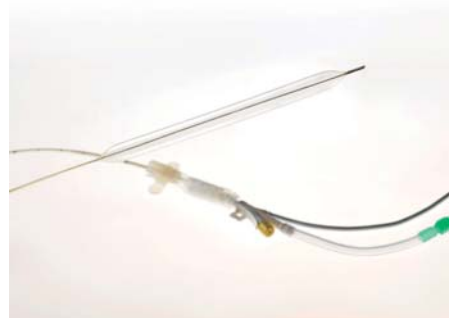

Contact Data

4646-2 Shinbashiya, Ootani, Basdai, yama  
969-3304 Fukushima, Japan

Phone: +81 242 73 3030  
Fax: +81 242 73 3390  
<http://atom-aizu.com>  
office@atom-aizu.com

Product Information

- Endoscopes and accessories

• Lathe turning, Cutting work, Grinding process, electro-discharge machining, Design work, OEM  
• Joint research with ATOM and Fukushima University Development of a small size multi-degree-of-freedom manipulator for medical applications using high precision 3D cam mechanism and crown gear reducer



Contact Data

D25-1, Gakuen Minami, Tsukuba, Ibaraki  
305-0818 Tsukuba, Japan

Phone: +81 29 8553189  
Fax: +81 29 8553181  
<http://www.cyberdyne.jp>  
contact@cyberdyne.jp

Product Information

- Walking and mobility support
- Support for walking and standing, and other support
- Training equipment

CYBERDYNE aims to introduce Robot Suit worldwide under a good relationship with the partners in each region. Our product Robot Suit HAL supplement, expand or improve physical capability of the wearer in the manner according to the wearer's intention.



Prof. Sankai, University of Tsukuba / CYBERDYNE Inc.

**Contact Data**

162-3,Ippongi,Yabuki-cho,Nishishira, kawa-gun,Fukushima-ken  
969-0236 Fukushima, Japan

Phone: +81 248 41-1110  
Fax: +81 248 42-5512  
tube-esq@abeam.ocn.ne.jp

**Product Information**

- Microscopes

I really appreciate you for the interests at our world finest metal tubes. Our tubes are used for varieties of industries such as medical aerospace and automobile. We are proud of supplying our products to globally well-known companies mainly in japan.

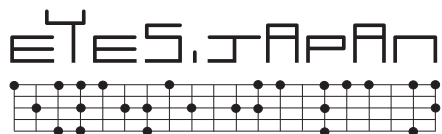
**Contact Data**

9-15 Higashisakae Aizuwakamatsu, Fukushima  
9650872 Aizuwakamatsu, Japan

Phone: +81 242 38-2023  
Fax: +81 242 38-2080  
<http://nowhere.co.jp>  
[info@nowhere.co.jp](mailto:info@nowhere.co.jp)

Babelhealth service is massively high-speed and ondemand DICOM platform using cloud. User can visualize volumetric images from MRI/CT on PC, various tablet devices and smartphones as a web service. Also the platform works with Osirix and other web services using WSDL.  
URL: <http://babelhealth.org>

**Contact Data**

139,Yokoyamacho, Skagawa-shi,  
Fukushima Pref. Japan  
962-0041 Fukushima, Japan

Phone: +81 248 75-3151  
[general.sales@hayashiseiki.co.jp](mailto:general.sales@hayashiseiki.co.jp)

**Product Information**

- Surgery Room Equipment

Company founded in 1921 as a manufacturer of Watch Case for SEIKO, began to produce Medical Devices featuring unique technology that is to enrich Nitrogen in the structure of Ferritic Stainless Steel, no Nickel contained, for characterizing superior resistance against corrosion and high hardness.

**Contact Data**

3-13 Kokaba 1-chome, Iwatsuki-ku, Saitama-shi  
339-0072 Saitama, Japan

Phone: +81 48 7948111  
Fax: +81 48 7948117  
<http://www.t-kaneko.co.jp>  
[kigawa@t-kaneko.co.jp](mailto:kigawa@t-kaneko.co.jp)

**Number of employees** 50-99  
**Sales volume** 1-9 Mio US \$  
**Export content** max. 10%  
**Year of foundation** 1956  
**Area of business**

- Electromedical equipment / Medical Technology

We are OEM high precision machining company who has been in medical device industry for. Especially we are experienced in machining direct insertion parts such as distal head of endoscope. We also conduct sub assembly, finishing and examination for the parts.



**Contact Data**

11 Monden-machi Industrial Park,  
Aizuwakamatsu-shi  
965-0845 Fukushima, Japan

Phone: +81 242 38 0103  
Fax: +81 242 38 0104  
p-and-m@ht-net21.ne.jp

What's New!?  
Medical & Machine  
Blood Pressure, Breast Cancer Checker, Blood Glucose  
Level, Micro Actuator, Scanning Haptic Microscope  
Contact us  
[http://www.ee.ce.nihon-u.ac.jp/~omata/sadao\\_omataE.html](http://www.ee.ce.nihon-u.ac.jp/~omata/sadao_omataE.html)

**Product Information**

- Equipment for gynaecological investigation and diagnosis
- Blood pressure equipment
- Laboratory equipment
- Devices and systems for glucose determination units



Scanning Haptic Microscope

**Contact us →**

[http://www.ee.ce.nihon-u.ac.jp/~omata/sadao\\_omataE.html](http://www.ee.ce.nihon-u.ac.jp/~omata/sadao_omataE.html)

**Contact Data**

5-27-10 Hongo Bunkyo-ku  
113-0033 Tokyo, Japan

Phone: +81 3 38155811  
Fax: +81 3 3815 5911  
info@toko-tool.co.jp  
www.toko-tool.co.jp

Through the manufacturing of cutting instruments which is "monozukuri" we have been engaged in Japan for over 70years, with the motto "cut" "grind" "shaping". Also we have concentrated on the development of medical instruments for artificial joint replacement surgery with our high-techniques.

**Number of employees** 20-49  
**Sales volume** 1-9 Mio US \$  
**Export content** max. 10%  
**Year of foundation** 1940  
**Area of business**

- Laboratory Equipment

**Product Information**

- Surgical instruments and products
- Instruments for bone surgery, fracture treatment and repair

**Contact Data**

7-15 Minamisakae-cho, Kasukabe-shi  
344-0057 Saitama, Japan

Phone: +81 48 761 1611  
ayako.tanaka@actment.co.jp

We exhibiting the Nitinol Medical device application products.  
Wire operation flexible tube is made by Nitinol bar and very simple and low cost.  
"Nail-Aid" is the Stent for ingrown toenails treatment. Its put it on easier than wire treatment, and low price, good with QOL.

**No more Pain!?**  
**EASY** Straighten Clip  
for Ingrown toenail.

**Company Figures**

**Number of employees** 50-99  
**Sales volume** 1-9 Mio US \$  
**Export content** max. 10%  
**Year of foundation** 1960  
**Area of business**  
• Physiotherapy / Orthopaedic Technology

**Product Information**

- Catheters (Commodities and Consumer Goods)

**Contact Data**

1-44-4, Tomigaya, Shibuya-Ku  
151-0063 Tokyo, Japan

Phone: +81 3 68268718  
Fax: +81 3 34816065  
<http://www.placenta-jbp.co.jp>  
y\_nouchi@placenta-jbp.co.jp

Since 1954, JBP produces placental extracts and develops innovative medical devices (CE Approved). JBP Nanoneedle is ultra-thin walled needle (34G) with less pain. JBP V Lift is embedding therapy needle with absorbable suture which causes quick face lifting effect without surgical treatment.

**Company Figures**

**Number of employees** 100-499  
**Sales volume** 10-49 Mio US \$  
**Export content** max. 50%  
**Year of foundation** 1954  
**Area of business**

- Electromedical equipment / Medical Technology
- Commodities and Consumer Good for Surgeries and Hospitals

**Product Information**

- Disposable articles for surgeries



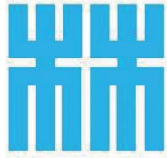

**Product Information**

- Visual support systems



**Contact Data**

4-8-8, Higashikanesawa-cho, Hitachi-shi, Ibaraki-ken, Japan  
316-0014 Ibaraki, Japan

Phone: +81 2 94341818  
MS@hayashibussan.co.jp

The support article for passing a hospitalization life comfortably is proposed. From an inner side, this product can use it in the case of movement and the walk which the public notice worries that an inner side can be hard to be seen from outside, although outside is visible.



**Area of business**

- Electromedical equipment / Medical Technology
- Diagnostics

**Product Information**

- System for Image documentation

We are the association of medical device companies in NAGANO prefecture of Japan. In this year, we are exhibiting some devices. "Display for Mammography", "Probes for Ultrasound Imaging Systems", "Pump for medical use/Dialyzer", "Magnetic Nanoparticles and Automatic Screening Equipment".

**Contact Data**

3-1-1, Asahi, Matsumoto  
390-8621 Nagano, Japan

Phone: +81-263-373529  
Fax: +81-263-373425  
<http://www.shinshu-u.ac.jp/group/smia>  
smia@shinshu-u.ac.jp



**Contact Data**

19F, Arcacentral Bldg., 1-2-1 Kinshi, Sumida-ku  
130-0013 Tokyo, Japan

Phone: +81 3 56117819  
Fax: +81 3 56117827  
<http://www.alcare.co.jp/e>  
nnagao@alcare.co.jp

We supply high-quality and reliable medical devices globally. Our product line varies wound, ostomy, nursing, and fracture care. Our factory in Japan comply ISO13485. SI-Aid is a Silicone-Faced Wound Dressing. A silicone gel dressing adheres flexibly and softly, and minimizes wound disturbance.

**Company Figures**

**Number of employees** 100-499  
**Sales volume** 100-199 Mio US \$  
**Export content** max. 10%  
**Year of foundation** 1955

**Area of business**

- Electromedical equipment / Medical Technology
- Diagnostics
- Physiotherapy / Orthopaedic Technology
- Commodities and Consumer Good for Surgeries and Hospitals

**Product Information**

- Dressings for wounds



**Contact Data**

2-3, Kuratsuki  
920-8203 Kanazawa-city, Ishikawa-prefecture, Japan

Phone: +81 76 2680121  
Fax: +81 76 2683577  
<http://www.tekkokiden.or.jp>  
info@tekkokiden.or.jp

**Company Figures**

**Number of employees** 500-999  
**Sales volume** 10-49 Mio US \$  
**Export content** max. 10%  
**Year of foundation** 1962

**Area of business**

- Electromedical equipment / Medical Technology
- Laboratory Equipment
- Physiotherapy / Orthopaedic Technology
- Information and Communication Technology

**Product Information**

- Analyser appliances



We have the group "MedicalCraft Ishikawa" consisting of 28 companies, which manufacture and develop medical, healthcare and welfare devices, components, units, parts, software etc. The member companies have distinctive own technology for these sectors.

**Contact Data**

86-1, Yatsumachi, Kanazawa-ku  
236-0016 Yokohama, Japan

Phone: +81 45 7915571  
Fax: +81 45 7915574  
<http://www.nanowave.co.jp>  
[info-s@nanowave.co.jp](mailto:info-s@nanowave.co.jp)

NANOWAVE MTS5R is a precision NC machine tool of desk top size.  
An unique spindle is a highly efficient thing that has run-out within 1 micron and can rotate until 20,000min<sup>-1</sup>, and can control angle positioning also. This machine tool can be used as a milling machine, and also as a lathe.

**Company Figures**

**Number of employees** 20-49  
**Sales volume** 1-9 Mio US \$  
**Export content** max. 10%  
**Year of foundation** 1995  
**Area of business** Laboratory Equipment

**Product Information**

- Laboratory items

**Contact Data**

3 Mibu Hanai-cho, Nakagyo-ku, Kyoto  
604-8551 Kyoto, Japan

Phone: +81 7 58235140  
Fax: +81 7 58235327  
<http://www.nissha.co.jp/english>  
[med2@nissha.co.jp](mailto:med2@nissha.co.jp)

NISSHA has expanded its business field from industrial electronics to medical and experimental area. We exhibit a device to detect pathogens rapidly and a system for damage-less cell sorting. We also show products to be applied to your equipments to make them more attractive and user-friendly.

**Company Figures**

**Number of employees** 500-999  
**Sales volume** > 500 Mio US \$  
**Export content** max. 75%  
**Year of foundation** 1946  
**Area of business**  
• Laboratory Equipment  
• Commodities and Consumer Good for Surgeries and Hospitals

**Product Information**

- Rapid tests - Microbiology

**Contact Data**

CollaboShiga21 2F, 2-1 Uchidehama, Otsu City  
520-0806 Shiga, Japan

Phone: +81 77 5111414  
Fax: +81 77 5111418  
<http://www.shigaplaza.or.jp>  
[shin@shigaplaza.or.jp](mailto:shin@shigaplaza.or.jp)

Next-generation diagnosis and treatment technologies will be studied and developed toward "Highly Advanced Medical Services Anytime, Anywhere", such as on-site advanced medical services at clinics, smaller, lighter and more intelligent.

**Company Figures**

**Number of employees** 20-49  
**Sales volume** 10-49 Mio US \$  
**Export content** max. 10%  
**Year of foundation** 1999

**Area of business**

- Electromedical equipment / Medical Technology

**Product Information**

- Professional institutions

**Contact Data**

956-2, Yura-Town, Ota-City, Gunma-Pref  
373-0036 gunma, Japan

Phone: +81 276 304020  
Fax: +81 276 304021  
<http://www.hearmec.com>  
[shibata@hearmec.com](mailto:shibata@hearmec.com)

Aluminum body material,  
All welding,  
White painted crystal finishing,  
You will not feel boring when you using it  
For a long time.

**Product Information**

- Rehabilitation equipment and devices





# JOB

## Contact Data

1-19-8 Shinyokohama, Kohoku-Ku  
222-0033 Yokohama-Shi, Kanagawa, Japan

Phone: +81 45 4730113  
Fax: +81 45 4730108  
<http://www.job-image.com>  
k.hara@job-image.com

JOB Corp. is an ISO13485 certified company. We have a wide range of products such as portable X-ray units and Mono-Tank Generators. We also devote our energies to develop compact and light weight X-ray machines and have been receiving a favorable reputation on the reliability point of view.

## Company Figures

**Number of employees** 50-99  
**Sales volume** 10-49 Mio US \$  
**Export content** max. 25%  
**Year of foundation** 1988

## Area of business

- Electromedical equipment / Medical Technology

## Product Information

- X-ray devices and accessories
- Mobile X-ray apparatus
- X-ray generators and tubes
- X-ray generators for radiotherapy and diagnostic radiology



## Sakamoto Sekkotsuin Ltd (Sakamoto Hallux Valgus Development Laboratory)

## Contact Data

89-20 NumaTtsuyama  
708-0824 City Okayama, Japan

Phone: +81 3 35825183  
Fax: +81 3 35050450  
<http://www.ks-7.jp>  
info@ks-7.jp

This athletic supporter "Bocchi-kun" is devised for the people in trouble with valgus hallux and pedialgia.

This is a patented product.

As soon as you wear "Bocchi-kun", you could realize it's very comfortable to walk in.

## Company Figures

**Number of employees** 1-19  
**Sales volume** < 1 Mio US \$  
**Export content** max. 10%  
**Year of foundation** 1991

## Area of business

- Physiotherapy / Orthopaedic Technology

## Product Information

- Rehabilitation equipment and devices
- Foot supports



# TSK

## Contact Data

1485-11 Soja-Machi, Tochigi-Shi, Tochigi-Ken  
328-0002 Tochigi, Japan

Phone: +81 3 35825183  
Fax: +81 3 35050450  
<http://www.tsklab.com>  
tsk@tsklab.co.jp

TSK Laboratory is a Japanese manufacturing company with a long history in producing specialty needles. We serve the medical, aesthetic, ophthalmology and dental market by offering high quality needles that are developed to meet specific design specifications and optimize medical applications.

## Company Figures

**Number of employees** 100-499  
**Sales volume** 10-49 Mio US \$  
**Export content** max. 75%  
**Year of foundation** 1974

## Area of business

- Diagnostics
- Commodities and Consumer Good for Surgeries and Hospitals

## Product Information

- Disposable articles for surgeries



## Contact Data

1-8-4, Higashikawasaki-cho, Chuou-ku, Kobe-shi,  
Hyogo-ken  
6500044 Kobe, Japan

Phone: +81 78 322-6341  
Fax: +81 78 322-6072  
<http://www.city.kobe.jp>

## Contact Data

D27 TCI 2-1-6 Sengen  
3050047 Tsukuba, Japan

Phone: +81 298 8046  
Fax: +81 298 8047  
takeshi.sato@atonarp.com

## Company Figures

**Number of employees** 1-19  
**Sales volume** 1-9 Mio US \$  
**Export content** max. 10%

## Area of business

- Electromedical equipment / Medical Technology
- Diagnostics

**Contact Data**

718-1, Katsurase-Cho  
515-1104 Matsusaka-shi, Mie-ken, Japan

Phone: +81 598 601827  
Fax: +81 598 600301  
<http://www.safetyweb.co.jp>  
[account@cosmos-corp.com](mailto:account@cosmos-corp.com)

**Company Figures**

**Number of employees** 100-499  
**Sales volume** > 500 Mio US \$  
**Export content** max. 75%  
**Year of foundation** 1987  
**Area of business**  
• Medical Services and Publications

**Contact Data**

3-2-8 Minatojima-minamimachi, Chuo-ku  
650-0047 Kobe, Japan

Phone: +81 78 3226341  
Fax: +81 78 3226072  
<http://www.ecous-jp.com>  
[info@ecous-jp.com](mailto:info@ecous-jp.com)

**Company Figures**

**Number of employees** 1-19  
**Sales volume** 1-9 Mio US \$  
**Export content** max. 10%  
**Year of foundation** 2003  
**Area of business**  
• Electromedical equipment / Medical Technology

**Product Information**

- System for Image documentation

**Contact Data**

2-20 Nishinomiya-Hama  
662-0934 Nishinomiya, Japan

Phone: +81 798 337555  
Fax: +81 798 337601  
<http://www.furuno.co.jp>  
[medical-sales@syspro.furuno.co.jp](mailto:medical-sales@syspro.furuno.co.jp)

**Company Figures**

**Number of employees** 1000-4999  
**Sales volume** > 500 Mio US \$  
**Export content** max. 50%  
**Year of foundation** 1951  
**Area of business**  
• Laboratory Equipment  
• Diagnostics

**Product Information**

- Units and systems for clinical chemistry
- Fully automatic units for clinical chemistry



Messe  
Düsseldorf  
Japan

**Contact Data**

New Otani Garden Court, 7th Floor,  
4-1, Kioi-cho, Chiyoda ku  
102-0094 Tokyo, Japan

Phone: +81 3 52109951  
Fax: +81 3 52109959  
<http://www.messe-dus.co.jp>  
[mdj@messe-dus.co.jp](mailto:mdj@messe-dus.co.jp)

Japanese innovation is coming to MEDICA and COMPAMED. For those interested in connecting with medical technology companies from Japan, we have your information. - visit us at our booth in Hall 16. If you'd like to learn more, drop by! We are here to help.

**Company Figures**

**Number of employees** 1-19  
**Year of foundation** 1995  
**Area of business**

- Medical Services and Publications

**Product Information**

- Trade literature
- Other publishing products

**Contact Data**

2-15-13, Hongo, Bunkyo-ku  
113-0033 Tokyo, Japan

Phone: +81 3 66863708  
Fax: +81 3 58443508  
[aoki1998@hotmail.com](mailto:aoki1998@hotmail.com)

**Company Figures**

**Year of foundation** 1998

**Product Information**

- Apparatus for sleep studies
- Apparatus for sleep apnoea diagnosis and therapy
- Respiration equipment
- Non invasive ventilation, devices for
- Patient monitoring systems / Measuring stations
- Oximeters, oxygen saturation meters
- Furnishing / Equipment for examination and treatment rooms, intensive care units and wake up rooms



company name	booth
1 Hitachi Regional Industrial Technical Support Center Incorporated Foundation	J33
2 Daiichi Fab Tech, Co., Ltd.	J33
3 Imahashi Co., Ltd.	J33
4 KAWAI IRON WORKS CO., LTD	J33
5 M.TECH Co., Ltd	J33
6 MITOSEIKO CO., LTD	J33
7 NISINO SEIKI CO., Ltd.	J33
8 Nogamigiken Co., Ltd.	J33
9 Ohnuki Manufacturing Industry Co., Ltd.	J33
10 OTSUKA Factory Co., Ltd.	J33
11 Sattespring Co., Ltd.	J33
12 Iwate Industry Promotion Center	K36

## Block Diagram

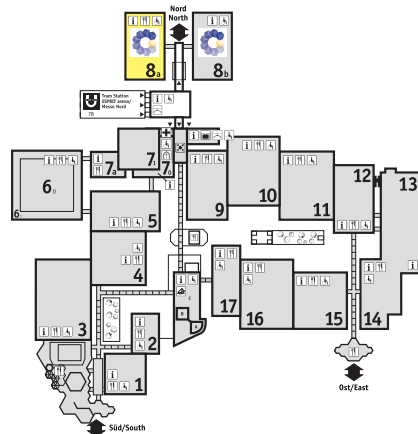

## Hitachi Regional Industrial Technical Support Center Incorporated Foundation



### Contact Data

2-20-1, Nishinarusawa  
316-0032 Hitachi-city, Pref. Ibaraki, Japan

Phone: +81-294-25-6121  
Fax: +81-294-25-6125  
<http://www.hits.or.jp/en/index.html>  
info@hits.or.jp

### Company Figures

**Number of employees** 1-19  
**Sales volume** 1-9 Mio US \$  
**Export content** max. 10%  
**Year of foundation** 1998  
**Area of business** Consultants

### Product Information

- Business development

## Daiichi Fab Tech, Co., Ltd.



### Contact Data

1-72 Yatu-chou  
311-4164 Mito-City, Ibaraki-Pref., Japan

Phone: +81 29 3037878  
Fax: +81 29 3037811  
<http://www.d-f-t.jp>  
info@d-f-t.jp

### Company Figures

**Number of employees** 20-49  
**Sales volume** 1-9 Mio US \$  
**Export content** max. 10%  
**Year of foundation** 1965  
**Area of business** Manufacturing Services

### Product Information

- Machining
- Metal stamping

## Imahashi Co., Ltd.



### Contact Data

20-42 Ishi Jyuou-cho  
319-1301 Hitachi-City, Ibaraki-Pref., Japan

Phone: +81 294 391161  
Fax: +81 294 391162  
<http://www.imahashi-ss.jp>  
ims@imahashi-ss.jp

### Company Figures

**Number of employees** 1-19  
**Sales volume** 1-9 Mio US \$  
**Export content** max. 10%  
**Year of foundation** 1991  
**Area of business** Manufacturing Services

### Product Information

- Machining
- Turning

## 4 KAWAI IRON WORKS CO., LTD

JAPAN 8a/J33

### Contact Data

4-9-14 Higashikanesawa-cho  
316-0014 Hitachi, Japan

Phone: +81 294 362333  
Fax: +81 294 330802  
http://kawai-iron.com  
hitoshi-kawai@kawai-iron.com

### Company Figures

**Number of employees** 50-99  
**Sales volume** 10-49 Mio US \$  
**Export content** max. 10%  
**Year of foundation** 1955

### Area of business

- Components, Parts, Original Equipment Manufacturers

### Product Information

- Anaesthesia products, rubber
- Filters, insert-moulded

## 5 M.TECH Co., Ltd.

JAPAN 8a/J33

### Contact Data

2-1-3, Tsudahigashi  
312-0032 Hitachinaka, Japan

Phone: +81 2927 24310  
Fax: +81 2927 51750  
http://www.m-tech61.com  
info.m.tech61@gmail.com

### Company Figures

**Number of employees** 20-49  
**Sales volume** 1-9 Mio US \$  
**Export content** max. 25%  
**Year of foundation** 1961

### Area of business

- Components, Parts, Original Equipment Manufacturers
- Manufacturing Services

### Product Information

- Cutting (Manufacturing Services)
- Micromachining

## 6 MITOSEIKO CO., LTD

JAPAN 8a/J33

### Contact Data

46-2 Yamazaki  
311-1254 Hitachinaka, Japan

Phone: +81 29 2658004  
Fax: +81 29 2658366  
http://www.mitoseiko.co.jp  
info@mitoseiko.co.jp

### Company Figures

**Number of employees** 50-99  
**Sales volume** 100-199 Mio US \$  
**Export content** max. 10%  
**Year of foundation** 1985

### Area of business

- Manufacturing Equipment
- Moulding and Extrusion

### Product Information

- Drilling
- Machining

## 7 NISINO SEIKI CO., Ltd.

JAPAN 8a/J33

### Contact Data

56 Yamazaki  
311-1251 Hitachinaka-City, Ibaraki-Pref., Japan

Phone: +81 29 2659595  
Fax: +81 29 2659090  
http://www.nisinoiseiki.com  
nobnishi@nisinoiseiki.com

### Company Figures

**Number of employees** 50-99  
**Sales volume** 1-9 Mio US \$  
**Export content** max. 10%  
**Year of foundation** 1968  
**Area of business** Manufacturing Services

### Product Information

- Machining
- Metal stamping

## 8 Nogamigiken Co., Ltd.

JAPAN 8a/J33

### Contact Data

1136-3 Izumi  
319-2144 Hitachiomiya, Japan

Phone: +81 295 532109  
Fax: +81 295 531228  
http://www.nogami-gk.co.jp  
sng@nogami-gk.co.jp

### Company Figures

**Number of employees** 50-99  
**Sales volume** 10-49 Mio US \$  
**Export content** max. 10%  
**Year of foundation** 1973  
**Area of business** Manufacturing Equipment

### Product Information

- Precision cutting tool
- Die-cutting (Manufacturing Equipment)

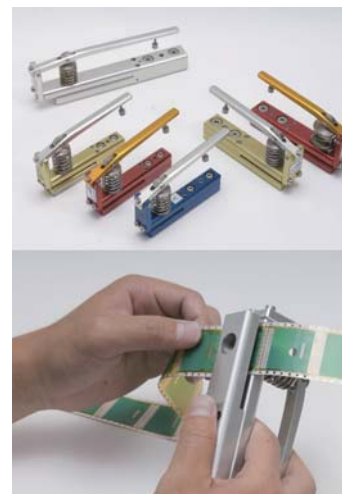

**SHARP CUTTING QUALITY:**  
Owing to Nogami's ultra-precision grinding technology of minimum clearance less than 0.005 mm, outstanding cutting quality will last for many hours. Regarding the metallic foil being tough to punch, it is capable to stamp out it with neither burrs, nor foreign substances.

## 9 Ohnuki Manufacturing Industry Co., Ltd. 8a/J33

### Contact Data

5-10-35, Moriyama  
316-0025 Hitachi, Japan

Phone: +81 294 533821  
Fax: +81 294 536839  
<http://www.ohnuki.co.jp>  
ohnuki@ohnuki.co.jp

### Company Figures

**Number of employees** 50-99  
**Sales volume** 1-9 Mio US \$  
**Export content** max. 10%  
**Year of foundation** 1956

### Area of business

- Components, Parts, Original Equipment Manufacturers
- Manufacturing Services

### Product Information

- Lamps
- Pressure forming

## 10 OTSUKA Factory Co., Ltd. 8a/J33

### Contact Data

1-64, Hosoda, Yatsumachi  
311-4164 Mito, Japan

Phone: +81 29 2514567  
Fax: +81 29 2524800  
<http://www.ohthuka.co.jp/>  
info@ohthuka.co.jp

### Company Figures

**Number of employees** 20-49  
**Sales volume** 10-49 Mio US \$  
**Export content** max. 10%  
**Year of foundation** 1949

### Area of business

- Components, Parts, Original Equipment Manufacturers
- Manufacturing Equipment

### Product Information

- Engineering
- Machining

## 11 Sattespring Co., Ltd. 8a/J33

### Contact Data

740 Koya  
306-0214 Koga-City, Ibaraki Pref., Japan

Phone: +81 280 922665  
Fax: +81 280 923454  
<http://www.satte-spring.com>  
sattesp@olive.ocn.ne.jp

### Company Figures

**Number of employees** 20-49  
**Sales volume** 1-9 Mio US \$  
**Export content** max. 10%  
**Year of foundation** 1983  
**Area of business** Manufacturing Equipment

### Product Information

- Springs, coiled
- Assembly systems

## 12 Iwate Industry Promotion Center 8a/K36



### Contact Data

3-35-2 Iioka Shinden  
020-0852 Morioka City, Japan

Phone: +81 19 6313827  
Fax: +81 19 6313830  
kenkyu@joho-iwate.or.jp

### Company Figures

**Number of employees** 50-99  
**Sales volume** 10-49 Mio US \$  
**Export content** max. 10%  
**Year of foundation** 1967

### Area of business

- Consultants
- Materials, Raw Materials
- Materials, Semifinished

### Product Information

- Metals, alloys

COBARION<sup>®</sup>, advanced cobalt-based alloy from Iwate, shows excellent mechanical properties, wear resistance and biocompatibility. We assist commercialization of the alloy, and exhibit the raw material and trial pieces manufactured by the company we support. Please visit us at 8aK36.



# Hall 8b

COMPAMED



company name	booth
1 EPSON ATMIX CORPORATION	K12
2 Futaku Precision Machinery Industry Comp	F26
3 MIKURO SPRING CO., LTD	E30
4 Nagano Techno Foundation Medical Industry Support Center	F41
5 JMC Corporation	F41
6 Kyoshin Co., Ltd.	F41
7 KYOWASEIKO CO., LTD	F41
8 Natsume Optical Corporation JAPAN	F41
9 Shinshu Ceramics Co., Ltd.	F41
10 UNISIS Corp.	J17
11 Yoshinogawa Electric Wire and Cable Co., Ltd.	K12

## Block Diagram

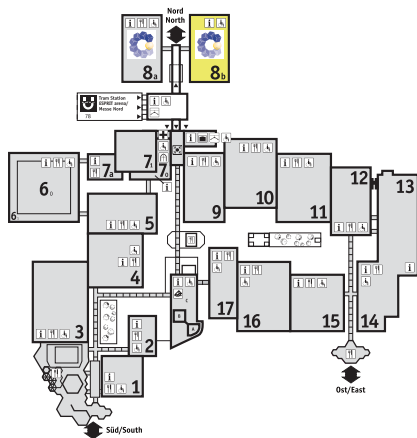

## 1 EPSON ATMIX CORPORATION



8b/K12

### Contact Data

4-44 Kaigan, Kawaragi  
039-1161 Hachinohe, Aomori, Japan

Phone: +81 178 732829  
Fax: +81 178 732810  
<http://www.atmix.co.jp>  
[sato.tomomi2@exc.epson.co.jp](mailto:sato.tomomi2@exc.epson.co.jp)

### Company Figures

**Number of employees** 100-499  
**Sales volume** 50-99 Mio US \$  
**Export content** max. 75%  
**Year of foundation** 1999

### Area of business

- Materials, Raw Materials
- Materials, Semifinished

### Product Information

- Metals, alloys
- Metals, stainless steel
- Metals, titanium

## 2 Futaku Precision Machinery Industry Comp



8b/F26

### Contact Data

33-3 Karahashi-Keiden-cho, Minamiku  
601-8454 Kyoto, Japan

Phone: +81 75661 2931  
Fax: +81 75661 2937  
<http://www.futaku.co.jp>  
[29futaku@futaku.co.jp](mailto:29futaku@futaku.co.jp)

### Company Figures

**Number of employees** 50-99  
**Sales volume** 10-49 Mio US \$  
**Export content** max. 10%  
**Year of foundation** 1953

### Area of business

- Components, Parts, Original Equipment Manufacturers
- Manufacturing Services
- Tubing

### Product Information

- Endoscopes
- Needles, custom
- Nozzles
- Polishing
- Tube-cutting

## 3 MIKURO SPRING CO., LTD



8b/E30

### Contact Data

22-6 Kowata Minami, Suwa-City  
392-0023 Nagano, Japan

Phone: +81 266 523550  
Fax: +81 266 582317  
<http://www.mikuro-spring.com>  
[miyasaka@mikuro-spring.com](mailto:miyasaka@mikuro-spring.com)

### Company Figures

**Number of employees** 50-99  
**Sales volume** 10-49 Mio US \$  
**Export content** max. 25%  
**Year of foundation** 1954

### Area of business

- Components, Parts, Original Equipment Manufacturers

### Product Information

- Springs, coiled

4

## Nagano Techno Foundation Medical Industry Support Center



8b/F41

### Contact Data

1020 Shimadachi  
390-0852 Matsumoto, Japan

Phone: +81 263 404051  
Fax: +81 263 473380  
<http://www.tech.or.jp/medical>  
me-techno@tech.or.jp

### Company Figures

**Number of employees** 50-99  
**Year of foundation** 2001  
**Area of business** Consultants

### Product Information

- Start-up assistance

5

## JMC Corporation



8b/F41

### Contact Data

7502-1, Kawaji  
399-2431 Iida City, Nagano, Japan

Phone: +81 45 4775757  
Fax: +81 45 471-5270  
<http://www.jmc-rp.co.jp>  
jmc ltd@jmc-rp.co.jp

### Product Information

- Quality management certificationservices

6

## Kyoshin Co., Ltd.



8b/F41

### Contact Data

4650 Nakasu  
392-0015 Suwa, Nagano-pref., Japan

Phone: +81 266 525030  
Fax: +81 266 523314  
[http://www.kyoshin-h.com/main/company\\_e.html](http://www.kyoshin-h.com/main/company_e.html)  
kyoshin@cello.ocn.ne.jp

### Company Figures

**Number of employees** 100-499  
**Sales volume** 10-49 Mio US \$  
**Export content** max. 25%  
**Year of foundation** 1962  
**Area of business** Manufacturing Services

### Product Information

- Assembly
- Turning

7

## KYOWASEIKO CO., LTD



8b/F41

### Contact Data

1646-5 Takmorimachi, Yamabuki  
399-3101 Shimoina-gun, Nagano, Japan

Phone: +81 265 358288  
Fax: +81 265 358339  
m.hori@kyowaseiko.jp

### Company Figures

**Number of employees** 100-499  
**Sales volume** > 500 Mio US \$  
**Area of business** Manufacturing Equipment

### Product Information

- Semiassembled components

8

## Natsume Optical Corporation JAPAN



8b/F41

### Contact Data

3461 Kamichaya, Kanae  
395-0808 Iida, Nagano, Japan

Phone: +81 265 222434  
Fax: +81 265 222467  
<http://www.mflens.co.jp/en/contact.html>

### Product Information

- Endoscopes

9

## Shinshu Ceramics Co., Ltd.



8b/F41

### Contact Data

35-46 Ookuwamuratono  
3995501 Kiso-gun, Nagano, Japan

Phone: +81 266 71-6556  
Fax: +81 266 76-2201  
<http://www.shincera.co.jp/>  
<http://earth-plus.jp/>  
kubota@shincera.co.jp

### Company Figures

**Number of employees** 1-19  
**Sales volume** 1-9 Mio US \$  
**Export content** max. 50%  
**Year of foundation** 1929  
**Area of business** Sterilisation

### Product Information

- Sterilants

**Contact Data**

4-11-4 Taito, Taito-ku  
110-0016 Tokyo, Japan

Phone: +81 3 58128832  
Fax: +81 3 58128831  
<http://www.unisis.co.jp/english>  
o-sales@unisis.co.jp

**Company Figures**

**Number of employees** 100-499  
**Sales volume** 10-49 Mio US \$  
**Export content** > 75%  
**Year of foundation** 1978

**Area of business**

- Components, Parts, Original Equipment Manufacturers

**Product Information**

- Needles, epidural and haemodialysis

UNISIS has been an expert company mainly focusing on anesthesia needle fields, and kept supplying puncture needle and biopsy needle on OEM basis for over 20 years. UNISIS esteems Japan Quality, and all products are "Made in Japan" to ensure high quality.

**Contact Data**

185-25 Showa-otsu, Sanuki-shi, Kagawa  
769-2304 Sanuki, Japan

Phone: +81 879 520601  
Fax: +81 879 520602  
<http://www.yoshinogawa.co.jp>  
s-kobayashi@yoshinogawa.co.jp

**Company Figures**

**Number of employees** 100-499  
**Sales volume** 10-49 Mio US \$  
**Export content** max. 10%  
**Year of foundation** 1948

**Area of business**

- Certification Bodies and Notified Bodies
- Clean Room Equipment, Supplies and Services

**Product Information**

- Cables (special cables, diagnosis cables)



When it comes to the Japanese medical and health market, there are few companies who have the same experience and insight that Messe Düsseldorf has. For the past 15 years, Messe Düsseldorf Group has been operating in Japan via its subsidiary Messe Düsseldorf Japan, Ltd., bringing Japanese exhibitors and visitors to the MEDICA & COMPAMED in Düsseldorf and related medical trade shows all over the world. During this time, we have built close relations with all major Japanese medical associations and other industry groups, and we have been continually monitoring the domestic medical and health-related devices market. Naturally, we follow international trends as well. Through our presence at the leading Japanese medical trade fairs, we exchange opinions with industry leaders and players, many of whom are repeat exhibitors at Messe Düsseldorf trade shows.

Based on our in-depth knowledge of the Japanese market and our strong network, we provide support to foreign companies in the medical and health business in the following areas:

- **Market Intelligence:** MDJ provides market studies on the structure of the Japanese medical market and its players. We also monitor trade journals to produce timely market intelligence reports for clients.
- **Trade Fair Participation:** Being a trade fair company, of course trade fair participation is our specialty! We handle all interactions with Japanese trade fair organizers, book the space, arrange booth creation, supply personnel and take care of every detail, including professional follow-ups with visitors and the press.
- **Market Access:** Messe Düsseldorf Japan will put you in contact with potential business partners, arrange meetings, and assist in preparing materials suitable for Japanese audiences. We handle the necessary follow-ups once you are at home, and help take care of your future customers.

In short: *We are here to help you!* Messe Düsseldorf Japan, Ltd.

**Dr. Andreas Moerke**, President

**Mr. Hironori Hattori**, Senior Project Manager

**Mr. Ansgar Jung**, Project Manager

**Mr. Munetoshi Yamamoto**, Advisor

Publisher of this directory:

Messe Düsseldorf Japan Ltd.

New Otani Garden Court 7F, 4-1, Kioicho,

Chiyoda-ku, Tokyo, Japan 102-0094

T: +81.3.5210 9951 • F: +81.3.5210 9959

M: mdj@messe-dus.co.jp

W: www.messe-dus.co.jp





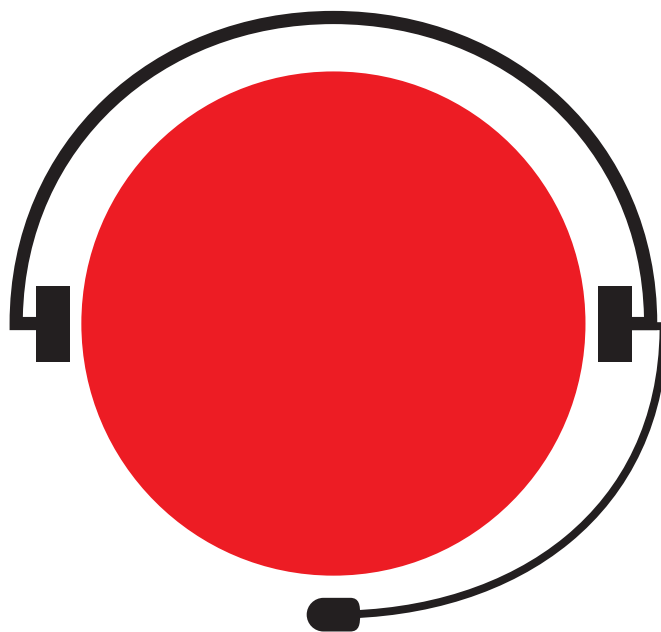

# Call right now to take advantage of **Japan's** medical business potential.

**Cellphone: +49-176-1006-0547** (14-17 Nov for MEDICA 2012 only)

**Phone: +81-3-3584-0322 Email: METI\_FDI@accenture.com**

**Website: [www.jetro.go.jp/en/invest/info](http://www.jetro.go.jp/en/invest/info)**

Welcome to the second-largest healthcare market in the world. To promote greater internationalization and to invite more companies from around the globe to invest in Japan, the Japanese Government introduces new attractive incentive programs. With recovery from the Great East Japan Earthquake progressing, it's an opportune time to take advantage of these programs. Call us now to learn more.